

TODAY'S MATCH
SPONSORED BY:
ROY ALLEN SUPPLIES
21 WESTMEAD
WESTLEA
SWINDON

S W I N D O N

 **BARCLAYS** DIVISION TWO
PORT VALE
SATURDAY 3rd MARCH 1990
KICK OFF 3.00 p.m.

OFFICIAL CLUB SPONSOR

OFFICIAL
PROGRAMME
80p

People and events in the news at the County Ground

MARTY SMITH'S MATCHFACTS



● Martyn Smith

v BARNSELY
 on SATURDAY FEBRUARY 10th 1990
 at OAKWELL
 BARCLAYS LEAGUE DIVISION TWO

WEATHER CONDITIONS: Cold, windy with light drizzle

Barnsley Team:

1. Baker
2. Thomas
3. Taggart
4. Fitcher
5. Shotton
6. Smith
7. Robinson
8. Gray
9. Glover
10. Agnew
11. Cooper

SWINDON TOWN SUBSTITUTES:

12. Cornwell (Jones (82 min))
14. Close (White (76 min))

BARNSELY SUBSTITUTES:

12. Banks (Cooper (72 min))
14. Lowndes (Gray (45 min))

SWINDON TOWN BOOKINGS:

None

BARNSELY BOOKINGS:

Cooper (61 min)

FIRST HALF DURATION:

46 minutes 48 seconds

SECOND HALF DURATION:

46 minutes 14 seconds

GOALS:

Swindon Town

Calderwood (35 min, 33 sec)

Barnsley

None

GOAL ATTEMPTS ON TARGET:

Swindon Town:

Shearer (9 min)

Shearer (14 min)

Shearer (15 min)

McLoughlin (28 min)

Maclaren (33 min)

Shearer (40 min)

McLoughlin (71 min)

Barnsley:

Cooper (25 min)

Agnew (49 min)

Robinson (56 min)

Agnew (73 min)

Taggart (84 min)

CORNERS:

First Half:

Swindon Town

Barnsley

5

2

Second Half:

3

5

REFEREE: A. Smith

LINESMEN: J. Everton and D. Mansfield

v CRYSTAL PALACE
 on TUESDAY FEBRUARY 13th 1990
 at SELBURST PARK
 ZENITH DATA SYSTEMS CUP
 AREA SEMI-FINAL

WEATHER CONDITIONS: Cold with occasional rain during first half

Crystal Palace Team:

1. Martyn
2. Pemberton
3. Shaw
4. Gray
5. Hopkins
6. Thorn
7. Barber
8. Thomas
9. Bright
10. Salako
11. Pardew

SWINDON TOWN SUBSTITUTES:

12. Cornwell (not used)
14. Hockaday (not used)

CRYSTAL PALACE SUBSTITUTES:

12. Hedman (not used)
14. Dyer (not used)

SWINDON TOWN BOOKINGS:

Kerslake (75 min)

CRYSTAL PALACE BOOKINGS:

None

FIRST HALF DURATION:

46 minutes 19 seconds

SECOND HALF DURATION:

46 minutes 49 seconds

GOALS:

None

Crystal Palace

Gray (15 mins, 34 sec)

GOAL ATTEMPTS ON TARGET:

Swindon Town:

Jones (10 min)

Shearer (13 min)

Jones (26 min)

Maclaren (48 min)

Maclaren (65 min)

Jones (88 min)

Crystal Palace:

Salako (81 min)

Thomas (56 min)

CORNERS:

First Half:

Swindon Town

Crystal Palace

2

5

Second Half:

4

4

REFEREE: J. Deakin

LINESMEN: P. Hardie and R. Saunders

THE GOODMANS OF HAVANT HAMPSHIRE RADIO/STEREO TWIN RECORDER AWARD WINNER John Rendell of Bradford-on-Avon



Our picture shows John receiving his award from Ossi Ardiles at a recent match.

Our thanks to Goodmans of Havant, Hants, for their generosity.

★ ★ ★

A warm welcome today to Paul Bishop and his friend from Liddington, who are our V.I.P. guests for today's match.

Paul purchased his day with us in an auction to raise funds for Liddington Village Hall.

We hope Paul and his friend enjoy their visit and that Liddington will soon have a new village hall.

**WELCOME TO THE PLAYERS,
SUPPORTERS AND OFFICIALS
OF PORT VALE**

**A NEW STRIKER
ARRIVES**

Congratulations to Steve White and his wife Mandy on the arrival of Joseph, their first child. Congratulations from all at the County Ground.



● Congratulations Steve
Today's Match Sponsor
Roy Allen Supplies
Doors, Locks, Latches
Builders Ware
21 Westmead
Westlea
Swindon

Today's Match Ball Sponsor
South Marston
Country Club

★ ★ ★

**IMPORTANT SAFETY
NOTICE**
Important safety
announcements by the
Club Management over
the public address system
will be preceded by a loud
signal to catch the
attention of spectators.

★ ★ ★

Chartered WestLB Limited
33-36 Gracechurch Street
London EC3V 0AX

Mr D Buswell
Commercial Manager
Swindon Town Football Club
Commercial Department
County Ground
Swindon
Wilts.

Dear Doug,

Many thanks for the excellent organisation of my Hospitality Package for the West Ham match last Saturday.

The diplomatic 2-2 draw left no-one entirely disappointed and the occasion, complemented by excellent weather and with the atmosphere enhanced by the large enthusiastic crowd, was thoroughly enjoyed by all of our party.

I wish the team a successful conclusion to the season so that hopefully we may contemplate a similar function next year at a First Division game!

Kind regards,

Yours sincerely
Peter Godwin
Managing Director

**SWINDON TOWN
FOOTBALL CLUB**

County Ground
Swindon

Our telephone numbers are as follows
Main Switchboard (general Enquiries): **642984**
Commercial Department: Ext **30 or 31**
Sports Shop: Ext **29**
Travel Club: **Tel: 611499**
Rendezvous Club: **Tel: 35130**

Please note that when calling from outside Swindon you should first dial 0793.

President

C. Green

Executive Directors

Chairman: B. Hillier

C. Howard

Vice Chairman: G. W. Herbert

L. Smart
N. Arkell

Non-Executive Directors

D. Alderton

R. Kearsey

R. Mattick J.P. (Company Secretary)

Commercial Manager

D. Buswell

Team Manager

O. Ardiles

Assistant Manager

P. Bates

Coach

A. Rowland

Youth Team Manager

J. Trollope

Physiotherapist

K. Morris

Groundsman

G. Warren

Maintenance Officers

M. Hughes

Kit Manager

B. Crewe

Receptionists

Miss L. Maberley

Miss J. Edwards

Miss M. McDonald

Sports Shop Manager

D. Woodman

HONOURS

Football League Cup

Winners: 1969

Semi-Finalists: 1980

Anglo Italian Cup

Winners: 1970

Football League Division Two

Play-Off Semi Finalists: 1989

Football League Division Three

Runners-Up: 1963, 1969

Play-Off Winners: 1987

Division Four

Champions: 1986 (with record 102 points)

F.A. Cup

Semi-Final: 1910, 1912

F.A. Charity Shield

Semi-Finalists: 1911

F.A. Youth Cup

Finalists: 1964

The official programme of Swindon Town
Football Club

Printed by Thamesdown Litho

Individual contributions made to our matchday magazine do not necessarily reflect the views of the Club.

THE WINNING COMBINATION



GWR

FM

FIRST FOR SPORT IN WILTSHIRE

We offer the most comprehensive sports coverage in the county.

Tune to 97.2 or 102.2 MHz for updates at:

06.45 07.45 08.45 13.10 17.15

Plus our weekend coverage starting on Friday at 17.15 with the exclusive Swindon Town coverage featuring Ossie Ardiles, players and management from the County Ground.

Saturday sport is a full four hours starting at 14.00 with detailed match coverage and radio's first classified football results at 16.55.

Welcome to Port Vale and especially to Tim Parkin. In the short time I worked with him Tim was a model professional.

Our last game at home to West Ham United was a very good advert for the game of football and credit to all the players involved. Although disappointed not to collect

the sparse coverage in the next days press of what actually happened on the field.

I received a letter from a Barnsley supporter, Matthew Naylor, which included the following:

I would like to congratulate your fans and players for their concern when two of our

for such a sporting gesture which is rarely seen today. As was the free kick played straight to our goalkeeper by your player following the incident involving Malcom and Paul. Well done Swindon.'

Thank you Matthew, things like that are what makes football the most beautiful sport in the world. It's a pity that these sort of things do not get the coverage they deserve.

We entertain Port Vale today who, after a shaky start to the season, have now started to pick up a lot of points and are comfortably placed in the League.

From our own point of view, every point counts and we are going to carry on pushing for promotion.

I was delighted with your support for the Leeds United and West Ham matches. Keep it going, the players and I certainly appreciate it.

Enjoy the game.



Ossie Ardiles

the maximum points I believe we deserved on the day, I was happy with our overall performance.

I was puzzled after the game, at the press conference, to see only a handful of reporters and

pleyrs, Malcom Shotton and Paul Futchter, suffered from a clash of heads. It was particularly gratifying to see the appause from your supporters when Malcom Shotton was helped off the pitch for treatment. May I express my thanks

Swindon Supporters in London Association sponsor Ossie Ardiles' kit.
CONTACT: Nick Coote 01-828 1437
Paul Donkersley 01-870 0316
David Moulard 01-347 9845

THE BOSS



LEMON & CO

SOLICITORS

*A SUBSTANTIAL PRACTICE ABLE TO
PROVIDE ADVICE & HELP IN ALL
ASPECTS OF COMMERCIAL & PRIVATE LIFE
AND INCLUDING A FRIENDLY, THOROUGH
AND PROFESSIONAL CONVEYANCING
SERVICE*

Richard Fry, Timothy Dixon, Deirdre Moss
34 Regent Circus
Swindon SN1 1PY
Tel: SWINDON 27141
Fax: SWINDON 614168

Martin Evans, Stephen Moss
148 High Street
Wootton Bassett SN4 7AB
Tel: SWINDON 853665
Fax: SWINDON 850324

Richard Challis, David Halfhead
1 Little London Court
Old Town, Swindon SN1 3HY
Tel: SWINDON 27141
Fax: SWINDON 511639

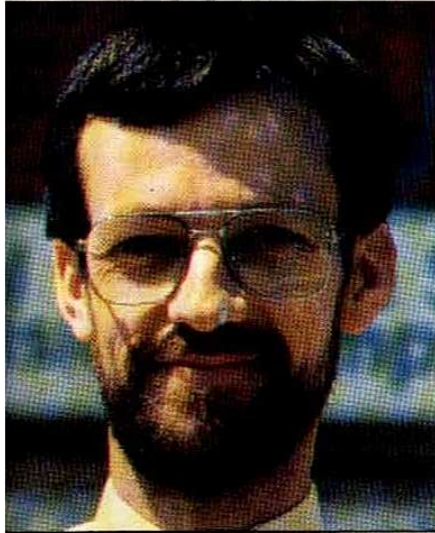

Paul Plowman

OUR HISTORIAN LOOKS BACK AT SOME PREVIOUS MEETINGS BETWEEN SWINDON TOWN AND TODAY'S OPPONENTS

Today will be the 43rd meeting between Swindon Town and Port Vale, of which all except one have been in the search for League points.

Vale made their first League trip to the County Ground a few months before the outbreak of War in 1939. Having, with the exception of three seasons, spent all their career prior to this in the Second Division, they now had to switch from the Third North to the Third South. The game ended in a 1-1 draw, with the Town goal coming from Stan Wilcockson.

BEFORE VALE PARK

In those days, Port Vale entertained at the Recreation Ground in Hanley. Swindon played there

on five occasions and could only manage to score twice in those 450 minutes. The second, scored by Bobby Peart on the Town's last visit in April 1950, was a winner.

Vale Park proved to be a less favourable venue for Swindon as, during the next 35 years, they collected just four draws from 14 visits. The only Town player ever to score more than once at Vale Park is Maurice Owen. His two goals in nine minutes brought Swindon back from 0-2 down in November 1951.

The best individual scoring feat went to Vale's Harry Oscroft, who hit four goals in his side's 6-1 victory at the end of 1959/60. After a three goal blast in the space of five minutes, Swindon were 0-4 behind after only half an hour. Oscroft had already claimed a hat-trick and to make matters worse, Town defender Peter Chamberlain also had the misfortune to put the ball past keeper Sam Burton.

Some twenty-five years after that match had taken place, it was named by soccer writer Simon Inglis as 'Soccer in the Dock' as one in which certain players had contrived to 'fix' the result. Jimmy Gauld, the Swindon player who was later imprisoned after being found guilty of partaking in such events, had scored the Town's only goal three minutes from time.

BOBBY'S SWITCH

In October 1960 it was Swindon's turn to deliver a six-goal salvo. Teenage wing-half Bobby Woodruff was switched to the centre-forward berth and responded quite magnificently. He opened the scoring after only seven minutes, added another in 24 and completed his hat-trick with twenty minutes to spare.

Two seventeen year-olds,

Ernie Hunt and Mike Summerbee, also got in on the goal-scoring act – as did Dave Corbett, the 'old man' at just twenty!

But the Vale Park hoodoo struck again in the following February when the Town suffered a 4-1 defeat. Former England youth Bert Llewellyn gave Port Vale the lead in the first minute of the game and although Swindon equalised just after half-time through Cliff Jackson they quickly conceded two more goals to Llewellyn and never again looked likely to recover.

Even in the Town's promotion season of 1962/63, our visitors from the Potteries recorded two League wins, both by the odd goal.

The Town's Port Vale 'famine' finally came to an end in October 1986. Chris Kamara and Steve White put them into a commanding 2-0 lead with barely ten minutes gone. Robbie Earle replied in the 21st, but Mark Jones – whose loan move from Oxford had just been made permanent – scored a crucial third five minutes before half-time.

KEEPING UP WITH THE JONES'S

The home side's Jones, Andy, put Vale back in the game on the hour – his 12th goal of the season – and then a header from Dave Bamber flew into the top of Fraser Digby's net to put the scores level at 3-3.

But within two minutes Jimmy Gilligan came to the rescue, to edge the Town back in front and see them safely home to take all three points. Swindon went on to record their only League 'double' over Port Vale when full-back Chris Ramsey hit a 25th-minute decider at the County Ground in the following March.

NEWSPAPER FOOT



NUMBER ONE IN WILTSHIRE,
97.2 MHz

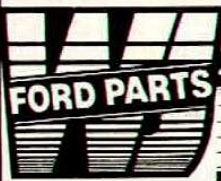

WALKER JACKSON



Check Ford First.

Take power. Supreme power.



£39.56

SUREPOWER 077
MOST FIAT, FSO
LADA RIVA.

40% OFF RRP

£33.63

MOTORCRAFT
ECONOPOWER 083
FIESTA 1.0, 1.1, 1.3, 1.6.

£21.07

MOTORCRAFT
ECONOPOWER 036A
AUSTIN METRO.

£39.15

MOTORCRAFT
SUPERPOWER 085
ESCORT 1.1, 1.3, 1.6.

£39.15

SUREPOWER 063
VAUXHALL CAVALIER
1.3, 1.6, 1.8.

£46.50

SUREPOWER 093
ESCORT, FIESTA
DIESELS.

EVEN SOBER DRIVERS GET STONED HEADLAMP COVERS FOR STYLE AND PROTECTION

A 4.546 LITRE CAN 10/30, 20/50, OR 15/40 SF/CD
MULTIGRADE OIL, PLUS OIL FILTER

TO FIT FORD KL, OHC, CVH, BL AND V ENGINES
ALSO SOME
PEUGEOT, RELIANT, RENAULT,
SAAB, TALBOT, TOYOTA
AND VOLVO ENGINES



£6.50 INC. VAT



BEFORE

1986 MODEL
ESCORT

£27.58

SCORPIO, GRANADA

£34.46



AFTER

Protection

The product evolved as a method of effectively protecting headlights and flashers, thus eliminating the high cost of replacing damaged sealed-beam headlamp units. Our covers are manufactured from tough, hard wearing 3mm cast acrylic sheet.

MOTORCRAFT SUPER PLUS

Antifreeze?

YOUR ALL YEAR
ROUND ENGINE
SAFEGUARD.



£2.99

1 LITRE

£5.32

2 LITRES

£10.43

4 LITRES

MOTORCRAFT SUPER PLUS IS THE ONLY ANTIFREEZE RECOMMENDED
FOR USE IN FORD VEHICLES PRODUCED SINCE AUGUST 1980

ALL PRICES INCLUDE VAT



OPEN ALL DAY SATURDAY



Walker Jackson & Co. Limited
CAR PARTS
Marlborough Road
Tel: Swindon 695702



Walker Jackson & Co. Limited
VAN AND TRUCK PARTS
Coped Hall, Wootton Bassett
Tel: Swindon 850225



A member of the
Normand Group
of Companies

PARTS CENTRE
OPEN SIX DAYS A WEEK
Monday to Friday
8am - 6pm
Saturday 8.30am - 5pm
PARTS CENTRE
OPEN SIX DAYS A WEEK
Monday to Friday
8.30am - 6.30pm
Saturday 8.30am - 3.30pm

THE ROBINS CORNER SHOP

LEISUREWEAR AND SOUVENIR PRICES

ARTICLE	Price £	P&P £	
AUTOGRAPH BOOKS	1.50	.25	
BABYWEAR			
Baby Bibs 'I Love Swindon Town'			
White, Pink, Sky, Lemon	.99	.19	
Baby Grows			
6-12 months, 12-18 months			
White, Pink, Sky, Lemon	4.99	.50	
BADGES			
Enamel Badges 'Crest'	2.00	.20	
Enamel Badges (Small) 'Crest'	1.00	.19	
Decal Badges	.99	.19	
Embroidered Badges 'Robins'	.85	.19	
Blazer Badges Embroidered 'Crest'	6.50	.20	
Button Badges	.25	.19	
Badge Brooch	.50	.19	
CAPS			
Flat	3.00	.50	
CAR STICKERS			
Crest (Square)	1.00	.19	
CLOCKS			
Wall	Batteries	9.50	1.10
Table (Small)	not included	2.75	.25
DESK TIDIES	1.99	.50	
*See other items with same design 10% Discount if you buy complete set			
ERASER	.35	.19	
FOOTBALLS LARGE	10.00	1.50	
Mini	2.99	.85	
GIFT PACK	2.99	.50	
*See Desk Tidies			
GLOVES MENS/YOUTHS	2.50	.35	
Boys	1.75	.35	
HATS SKI JACQUARD	3.00	.35	
Bob	2.85	.35	
SCARVES Acrylic	2.85	.50	
Jacquard	3.50	.50	
Headsquares	5.50	.50	
SHIRTS			
Polo/Leisure Embroidered Crest	10.50	1.00	
White, Red & Black S.M.L.XL			
Rugby 'Embroidered Crest'	15.50	1.20	
Red/White S.M.L.XL			
Rugby 'Embroidered Crest'	16.50	1.20	
Red, White & Black Stripe			
S.M.L.XL			
Long Sleeved Cotton Training Tops	13.50	1.20	
Black, Red			
SOAP TIDIES	.99	.40	
*See Desk Tidies			
SWEATERS			
Acrylic 'Club Crest' V. Neck S.M.L.	13.75	1.50	
Red, Navy	XL	14.50	1.50
Acrylic Slipovers V. Neck	10.50	1.00	
Red, Navy S.M.L.XL			
SPOONS 'Crested'	1.50	.30	
SWEATSHIRTS			
White/Navy 'Marco' One size	16.50	1.50	
Red/White 'Ziggy' S.M.L.XL	14.50	1.50	
Red/White 'Ziggy' Childrens	12.50	1.00	
28-30 30-32			
BOMBER JACKET Navy/Red	17.50	1.50	
ROCKY I Red/Black One size	16.50	1.50	
ROCKY II Red/White	14.50	1.50	
(with Flacket & Poppers)			
One size			
RELAX Red/Black Collar	All Sizes	12.50	1.50
Navy with Red Collar	All Sizes	10.50	1.50
Red/Black Stripe	All Sizes	13.50	1.50
POLO NECK S/SHIRTS			
Red/Black	All Sizes	13.50	1.50

ARTICLE	Price £	P&P £
JACKETS		
Body Warmers		
'Embroidered Crest'		
Grey, Black & Red S.M.L.XL	12.50	1.50
LONG Grey/Red	26.50	1.50
Bomber Jacket Black, Red	22.50	1.50
JOGGING PANTS (Flock Print)		
Grey & Navy	11.50	.85
Junior Jog Suits 'Junior Robin'	10.50	.75
KEY RINGS		
Key Fobs Leather (Metal Crest)	1.50	.25
Novalty Key Rings (Assorted)	1.00	.25
Leather Key Rings (Stamped Crest)	.65	.25
MUGS		
Figures 89/90	1.85	.75
Standard White	1.85	.75
PENCILS with eraser		
Red, Gold, Grey	.25	.18
PENCIL CASES	1.00	.35
PENNANTS SATIN		
Shield Large	3.50	.45
Shield Small	2.50	.35
Round Small	2.50	.35
PENS		
White with Crest	.35	.18
Red S.T.F.C.	.35	.18
Red/White S.T.F.C.	.35	.18
PHOTOGRAPHS (Team)	2.80	.40
(Individual)	1.00	.30
PROGRAMME BINDERS	3.50	1.00
ROSETTES	1.20	.30
RULER 'Swindon Town F.C.'	.75	.30
T SHIRTS		
Crested T Shirt White, Red, Black	5.50	.65
S.M.L.XL		
ON VACATION		
White only S.M.L.XL	5.00	.65
LADIES PORTUGUESE TOP		
(Assorted Colours) S.M.L.	3.99	.50
TEDDIES		
Car	3.95	.75
TIES		
Navy Diagonal Red & White Stripe	5.75	.50
Grey Diagonal Red & White Stripe	5.75	.50
(Swindon Town F.C. Embroidered)		
TOOTHBRUSH HOLDERS	.99	.35
*See Desk Tidies		
TOWELS		
Bath Size 'Club Crest'	5.50	1.50
UNDERWEAR		
Ladies Briefs	1.25	.30
'I've Scored at the County Ground'		
Blue, Lemon, White, Aqua		
One Size		
Ladies Red/Black Lace Panties	2.50	.30
One Size		
Ladies Red/Black Lace Garters	1.50	.20
One Size		
Ladies Red/Black Lace Suspenders	3.50	.30
One Size		
(Full Set)	6.99	.50
Boxer Shorts	5.99	.50
('Club Crest')		
S.M.L.XL		
Nightshirts	5.50	.50
Tales of the County Ground'		
(Ex L Only)		
WRISTLETS	1.00	.30
WASTE BINS	5.99	1.00

All items can be obtained from the 'Robins Corner' shop and the North Stand Kiosk on all First XI Match Days. Also from the Commercial Department S.T.F.C. Monday to Friday during normal office hours, 9 am - 5 pm and First XI Match Days or ring Swindon 642984 ext. 30 or 31.

145 years of traditional ales.

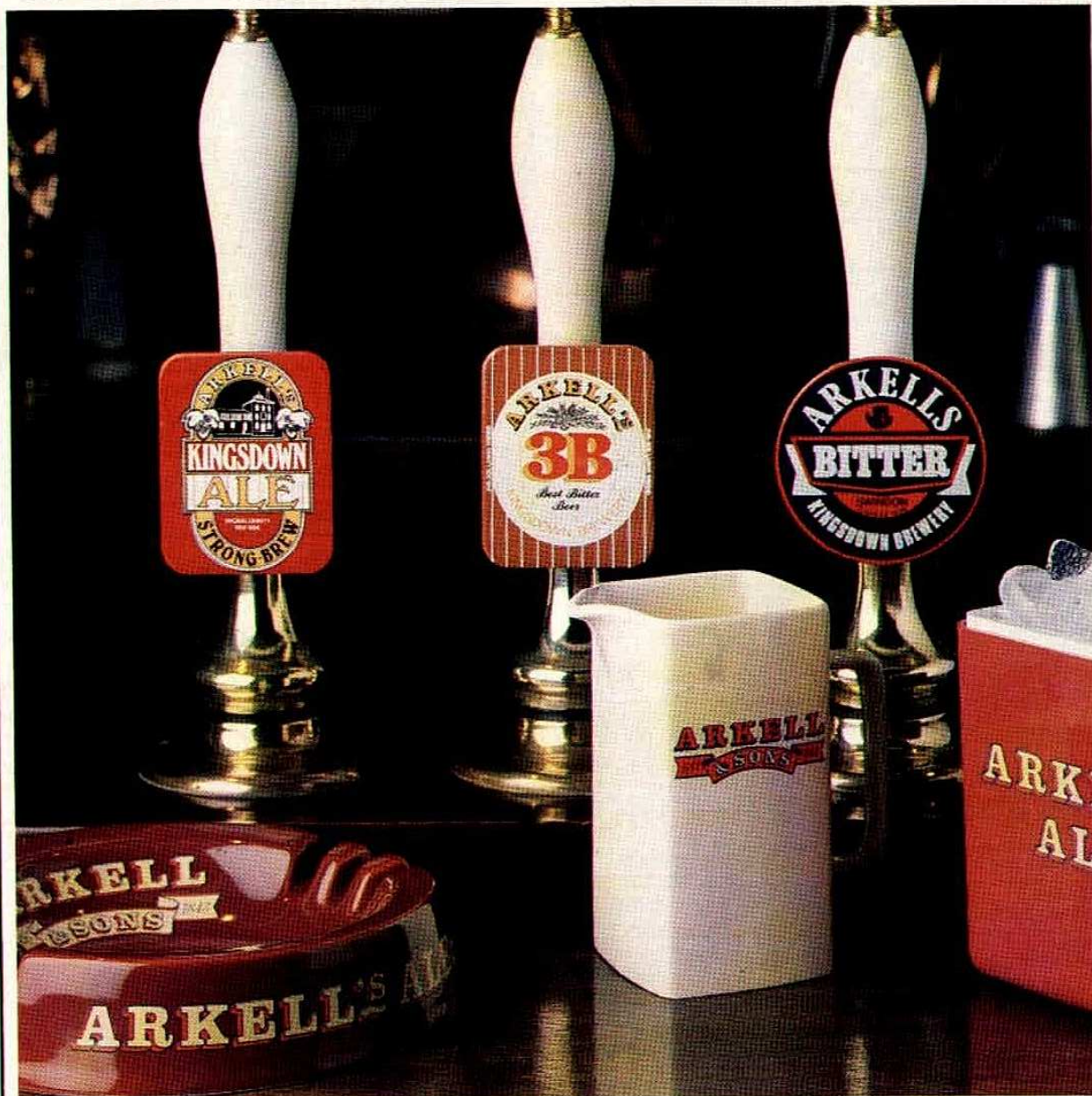

Ask for Arkell's. It's full of Wiltshire flavour.

Kingsdown Brewery, Stratton St. Margaret, Swindon. Telephone: 0793 823026

ARKELL

EST & SONS 1843

We all came off the pitch at Fratton Park last Saturday disappointed in that we had not taken all three points.

After Alan McLoughlin had put us level, with about 25 minutes to go, we had two or three good chances to wrap it all up.

If we had, it would have really put pressure on the two Clubs above us, Leeds United and Sheffield United.

Despite an early goal from Chris Kamara, Leeds only drew 2-2 with West Bromwich Albion and Sheffield United managed only one point from their home game with Newcastle United.

So a win at Pompey would have pulled us back another two points.

Even so, our point at Portsmouth meant we did not lose any ground – and that's almost as important.

As the gaffer said afterwards, there were other pluses.

One was that we played some of the best football we've produced over the past few games.

Another was that we were all disappointed after picking up an away point.

As Ossie pointed out, it showed that we were not happy with second best, which has to be a good sign for a side with their sights set on promotion.

Of course, we have to accept that there will be times when we play well, but don't get what we deserve.

Our performance at Portsmouth was a lot better, I felt, that the one against West Ham United the previous weekend.

The main thing about that game was that my worst fears about our old mate Jim Quinn proved well founded.

In the programme notes I said we would have to keep a special eye on him, because he was dangerous from anything up to 30 yards.

So when he banged in his first goal from about 25 yards, I almost wished I hadn't said anything.

Actually, he didn't seem to get a clean strike on the ball. But the shot was so well placed, just inside the post.

Even so, Fraser felt he should have got it. He seemed to get down behind the ball, but it bobbed up over his arm.

Quinn's second goal was one I felt we should have prevented.

He took the final header brilliantly, but I don't think he could have directed it that well if he had been under any kind of challenge.

Colin
Calderwood



The trouble was that he hadn't been picked up after taking a throw-in to Julian Dicks, who crossed it to the far side of the area.

Quinn had meanwhile run on to the pitch and was in the space between David Kerslake and Jon Gittens when Dicks's cross was headed back across our penalty area.

So he was virtually un-marked as he headed it in from the far post.

It's goals like that which we've got to prevent before we can class ourselves as a good side.

Mind you, there may not be many who will actually remember too much about the game against West Ham United.

Most of the talk afterwards centred around the resignation of our former boss Lou Macari as Manager of the Hammers.

To be quite honest, I was not surprised by his decision. The battering he has been taking from the media has been incredible.

I can't remember anybody taking such a bashing before. Even the train robbers never hit the headlines as much.

So, his decision to quit West Ham certainly did not surprise me.

I will be surprised, however, if e doesn't bounce back.

Once he has sorted out a few things, I'm sure we shall see him return to where he belongs ... to a job in football.

Today we welcome back another of our former players ... one of my old defensive mates Tim Parkin.

Tim has been on the bench mainly for Port Vale since joining them at the start of December, but I'm sure it won't be long before he gets into their side and stakes his claim.

I hope, by the way, he doesn't come on and score two goals!

WEST HAM UNITED - 25 NOVEMBER



BETTER BUY BURMAH

Burmah Petroleum Fuels Limited
is proud to support Swindon
Town Football Club and offers a
warm welcome to all supporters
at:

Swindon Autopoint
Marlborough Road, Swindon

Newport Street Autopoint
Newport Street
Old Town, Swindon

Stratton Autopoint
67 Bridgend Road
Stratton St Margaret, Swindon

St. Margarets Garage
Highworth Road
Stratton St. Margaret, Swindon

Swindon Automobiles
Dorcan Way, Swindon

Blagrove Autopoint
Great Western Way, Swindon

Bath Road Autopoint
Bath Road
Old Town, Swindon

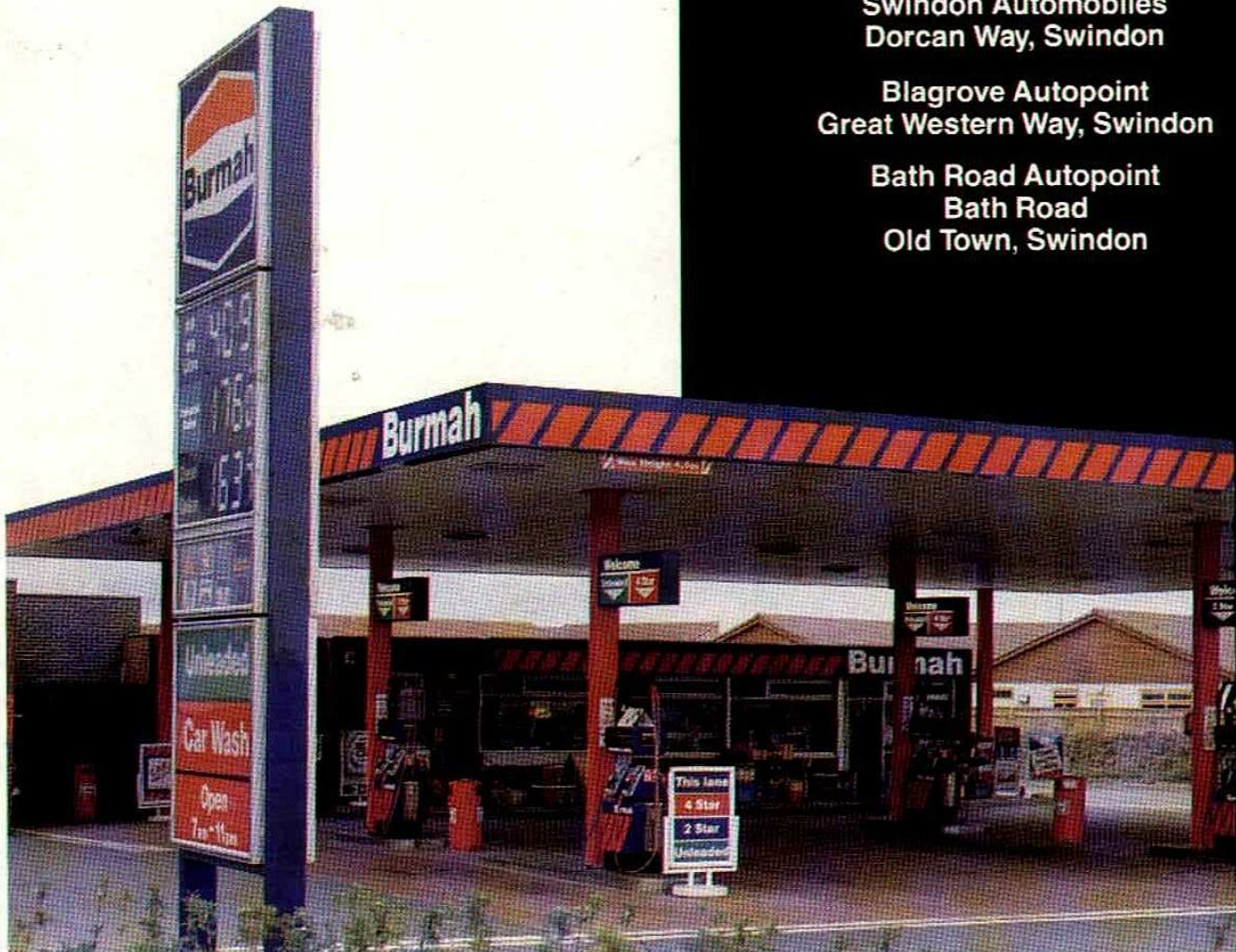

The New Burmah Autopoint at Blagrove



*Look out for the Burmah
Footballs kicked into the
crowd at every home match!*



**THIS COLUMN
NOW WRITTEN BY
GRAHAM CARTER**

Please God, please don't make us go through the play-offs again. Though coming third, fourth, fifth or sixth is preferable to coming seventh, it would be nice if we could get automatic promotion. At least some of us might be able to sleep at night in May. Is the Sheffield United bubble ever going to burst? They even rub it in now by equalising in the last minute.

We come to today's match after what is, by our standards, a bad run. Two whole games without winning! The West Ham game was never the classic we had hoped for and perhaps the draw was a fair result. In the end we paid the price for letting Jimmy Quinn have more room than we know we should have allowed him.

We never really showed the style which has led several national papers to say we are 'likely' to get promotion. Yet, when I spoke to a colleague for whom the West Ham match was the first he'd seen this season, he said how impressed he had been. I naturally explained what he'd been missing all season.

After West Ham we had 'one of those days' at Portsmouth. Even so, consistency wins promotion and we have still lost only one League match since the middle of December.

Where referees are concerned, the last thing you can expect is consistency. We all know that most of the time a centre forward only has to look at a goalkeeper and it's an instant free-kick. But the next minute a goalkeeper is tripped in front of the TV cameras at Newcastle and it's a goal. Worst of all was the 'tackle' by the Dutch 'keeper in the recent match against Italy. The 'keeper must have thought himself lucky to escape without a lengthy ban let alone stay on the pitch. Did you see it on Saint & Greavsie?

Talking of TV, did you know that Joe Jordan is the brightest young manager in the country? Well he is

according to HTV and you'll never catch them being biased. Perhaps they'll get round to noticing Ossie after they've finished telling us about the rugby, a ten-year-old gymnast from Yeovil and Mangotsfield United's exciting 0-0 draw in the Great Mills League against Chard. (And BBC West are not much better). Anybody know how I can pick up Central?

And, while I'm at it, has anybody told the big noises at ITV where Manchester United are in the League? I feel as if we should all be made honorary members of the United fan club the number of times

about Ossie and coaching badges and Ron Atkinson was very well informed. Has Big Ron bought a season ticket at the County Ground? It sounded as if he had.

And so to today's game. We welcome Port Vale to the County Ground despite memories of a game back in the Fourth Division days (not so very long ago). We were miles clear at the top and they came with no intention of going home with anything but a 0-0 draw.

Our encounter at Vale Park earlier this season was an entirely different matter. They looked im-



by **Michael Scott**

we've seen them this season. Won't somebody tell them the old Match of the Day/Big Match format was better anyway?

If, like me, you managed to find somebody with Sky, you might have been impressed with their coverage of the Zenith Data Systems Trophy match at Palace. Though giving Rupert Murdoch a free plug is against my nature, I have to say that their coverage was of a far higher standard than BBC or ITV, despite the disco music over the slow motion. For once, the 'experts' sounded like just that. Lawrie MacMenemy talked a lot of sense

pressive and played some open, flowing football. Their subsequent climb up the table has been good to see, but not surprising.

That day at Vale Park was another of those days when the ball refused to run for us. We knew it wasn't going to be our day when we hit the bar twice in the space of two seconds. Let's hope Vale get to see how we can play when the ball runs a little more kindly.

No cheap laughs today about Bristol City. I'm not even going to mention how they got on at Cambridge. (That's funny - HTV hardly did either).

S
P
O
R
T
S
V
I
E
W
S

are the
talk of
the Town



GWR FM

**ON 97.2 MHz
CALL THE RADIO LINE FOR THE
LATEST SPORTS NEWS 24 HOURS A DAY
ON 0898 333000**

Calls charged at 30p/min peak/25p/min all other times

THE SWINDON TOWN FOOTBALL CLUB SOCIAL CLUBS

We have two Social Clubs, the Rendezvous Club and the Supporters Social Club and, like all Clubs today, we are always looking for new members who will use the facilities as often as possible.

The Rendezvous Club is open evenings only, Wednesday to Sunday and Sunday lunchtime, except matchdays when it is open before and after the match. On Wednesday and Sunday there is bingo and on Saturday evening dancing takes place until 11 p.m.

In the Supporters Social Club there is a good variety of things to do, such as snooker, pool, darts, cards, dominoes and, again, on Tuesday, Friday and Sunday there is bingo in the large hall. Unlike the Rendezvous Club the Supporters Social Club is open every lunchtime and every evening.

Why not come along and see for yourself, I will be glad to show you around and answer any questions you might have.

There is also a large hall for hire to members for private parties and there are no parking problems whatsoever.

So come along and join us.

Ron Manners
Social Clubs Manager

For details of joining either Club ring Swindon 521570 and ask for Ron or ring Swindon 642984 ext. 26.



**SWINDON TOWN,
IT'S OUR TEAM**



Shaun Close
 • Compton Welding
 Purton, T70742
 † V & G Newman
 Lea, Malmesbury
 • Tudor Carpets
 Seymour Rd. Swindon
 ▲ John Ward
 New Farnley, Leeds
 ■ Jefferies DIY
 High St., Highworth



SWINDON TOWN



Chic Bates

† }
 • } **Julian Wilson**
 ▲ }
 ■ }



Nicky Summerbee

† }
 • } **Sir Seton**
 ▲ } **Wills**
 ■ } **and family**



Alan McLoughlin

• Jenco Industrial
 Services
 † John Harris
 Westcott Place
 • Post Office
 Swindon
 ▲ Martyn Smith
 Market Stores
 ■ Sandra Coburn



Paul Bodin

† }
 • } **The Robins**
 ▲ } **Out of Town**
 ■ }



John Gittens

† }
 • } **Cliff Jones**
 ▲ } **Wessex**
 ■ } **Aluminium**



Kevin Morris

• Mrs. Maslen
 from Bristol
 † 1 Graham, Southampton
 Street, Swindon
 • Mr. Maurice Earl
 ▲ Geoff James
 of Banbury
 ■



Colin Calderwood

• Jenco Industrial
 Services
 † Don Rogers
 • Mr. T. Barnes
 Ashton Keynes
 ▲ R. K. Owen, Fresian
 Close, Swindon
 ■ Sharon and Trevor
 Chamberlain



Nicky Hammond

† }
 • } **Allied**
 ▲ } **Dunbar**
 ■ }



Adrian Viveash

• Raynor J.R. and Son
 Vehicle Dismantlers
 † Broadtown
 Swindon
 • Tel. 863715
 ▲
 ■



John Cornwell



† }
 • } **T.S. Typesetting**
 ▲ } **Typesetters of the**
 ■ } **official S.T.F.C.**
matchday programme.
 Tel. (0793) 618905



Dave Hockaday

• Mr. K. Chillcott
 Ash Walk, Warminster
 † Rons Stores
 196 Rodbourne Road
 Swindon
 • Wilts
 Cannon Sports
 Wootton Bassett
 ▲ Colin Aldridge, The
 Dormers, Highworth
 ■



Duncan Shearer

† }
 • } **Bassett**
 ▲ } **Bookmakers**
 ■ }



Fraser Digby

• Mrs. Fisher, Birdcombe
 Walk, Swindon
 † Mrs. Chillcott, Ash
 Walk, Warminster
 • The Brown Family
 of Carterton
 Alexander Insurance
 Services
 ▲ S.T.F.C. Supporters
 Skittles Team
 ■ Top Cue' Stonehouse



Tom Jones

† }
 • } **Modular**
 ▲ } **Marquees**
 ■ } **(06667) 246**
Mr Jonothan
Powell Esq.



Fitzroy Simpson

† }
 • } **The Austin**
 ▲ } **Rover Group**
 ■ }



Steve Foley

• Jason and Duncan
 Malcom, Bulford
 † Graham Mulcahy
 Wills Club, Swindon
 • Mrs. Chillcott 34 Ash
 Walk, Warminster
 ▲ Jenco Industrial
 Services
 ■ 'Bring The Noise'



David Kerslake

• Bryant School of
 Motoring, Tel. 823421
 † Jenco Industrial
 Services
 • Mary Hower Take
 Away, Groundwell Rd.
 ▲ Mr. Fisher, 50 Bird
 Combe Walk, Swindon
 ■ Miss N. Williams 50
 Purley Ave., Swindon



Steve White

† }
 • } **Multisets**
 ▲ } **For all**
 ■ } **computer**
stationery
(0793) 729500



Tony Galvin

† }
 • } **Transplant**
 ▲ } **Ltd.**
 ■ } **Swindon**



Ross Maclaren

• John Tremlin, Coped
 Hall Service Station
 † Terry Wollen, Wollens
 Off Licence
 • Mr. Paul Raeburne
 JLR RCT, Colerne
 ▲ Gerry Williams
 The Ring Cafe
 ■ Rebecca Vockins,
 Priory Green



Paul Hunt

• In Focus,
 Wootton Under Edge
 † Mr. and Mrs. Tucker
 of Seend
 • Roland Jones and Peggy
 Postma, Ohegenham
 ▲ Robert Yallop Swindon
 Sharon Weston
 ■ of Wroughton
 Liana Hunt of Chisleton

KITSAWARDS



**PAUL FLOWMAN
LOOKS AT THE CAREER OF A
PLAYER WHO SERVED BOTH
SWINDON TOWN
AND TODAY'S OPPONENTS**

There have not been too many goal-scorers in post-War League football who have averaged a goal every other game. To maintain that average over some thirteen seasons is a magnificent achievement. Ralph Hunt was one such goal-scorer. The 1961/62 season was spent by Ralph at two homes - Swindon and Port Vale.

SLOW START IN THE SOUTH

Portsmouth born, Ralph Arthur Robert Hunt signed for his home-town Club on his 17th birthday, in August 1950. But it was not until December 1952 that he made his League debut, at Middlesbrough, in the First Division. Ralph made just four more League appearances for the Fratton Club before moving along the south coast to Dean Court in February 1954. With no goals for Pompey and only seven in 33 League games for Bournemouth, there was as yet little sign of the scoring prowess that would soon become evident.

In July 1955, Ralph joined Norwich City and was an 'overnight' success, blasting 33 League and Cup goals. Only Torquay's Sam Collins finished with more goals in the Third South and had it not been for a leady defence, the Canaries would have challenged the leaders instead of ending in seventh place, one point behind the Devonshire Club.



● Ralph Hunt

Ralph netted another 21 goals in 1956/57 but again the goals against proved to be the downfall of the East Anglian side. They were forced to make an application for re-election having taken the 'wooden spoon'. Only City's partners in distress at the bottom had conceded more than their 94 goals - Swindon Town!

RE-ELECTION RIVALS

But even a struggling Town had exposed the Canaries' defensive frailties, at Carrow Road in November, when they had raced into a 3-0 lead inside the first half hour. Ralph Hunt pulled back two goals but Swindon still recorded a 4-2 victory.

Ralph spent one more season with Norwich before signing for Second Division Derby County for £4,200 shortly

could hardly have started better. In the annual Reds v Blues public practice game he found the net inside 30 seconds!

His first eight competitive outings yielded only three goals, the first coming at Coventry in the opening away fixture. It came in the 43rd minute, not in itself a remarkable statistic.

Ralph then scored in six successive Town games, including a League Cup victory over First Division Birmingham City. But of the seven goals netted in that period no less than five had come in the five minutes before or after the break!

Ne netted another quick goal - after 55 seconds - in a pleasing 4-1 derby win over Reading but was soon on the move again, on December 8, to Port Vale for £3,500.

Passing Back



Paul Plowman

before 1958/59 got under way. But a year later he was back in the Third, with Grimsby Town. With the Mariners, Ralph knocked in 33 goals in only 39 League games in 1959/60 and, with strike partner Ron Rafferty, accounted for 57 of the Club's 87 goals. Grimsby finished fifth.

Ralph's next move was to Wiltshire, on June 23 1961. The Cleethorpes Club took Welsh Under-23 winger Freddy Jones in a player-exchange deal.

His arrival at the County Ground brought confusion in some quarters as the Town side now fielded 'R. Hunt' at both inside forward positions. Fortunately for the fans, the other Mr. Hunt, Roger by name, preferred to be known as Ernie.

NET PRACTICE

Ralph Hunt's debut in a Swindon shirt

However, prior to his departure, Ralph popped in his last two goals for the Town against Bradford Park Avenue. And, yes, they both came within five minutes of the interval - in the 43rd and 49th minutes!

On his home debut at Vale Park, against Shrewsbury, Ralph struck a whirlwind hat-trick - in just 16 minutes. But he found the net only three times more before joining Newport County in the summer of 1962. He was top scorer for the Fourth Division side with 27 League goals.

A further move took him to Chesterfield in 1964. Just before Christmas, he went with three other players to watch Third Round Cup opponents Peterborough. On the return journey, the car in which they travelled was involved in a collision at Grantham. Ralph Hunt died from injuries he received. He was 33.



SWINDON
TOWN

CLUBCALL
PHONE NOW

0898 12 16 40

SWINDON TOWN CLUBCALL

0898 12 16 40

All the news from The County Ground

- Reports 24 hours **EVERY** day.
- Phone now for exclusive news and interviews from the club.
- Match reports from home and away games as they happen.
- All the inside stories plus much much more.

CLUBCALL INDEX _____	0898 12 11 92
SHOOT SOCCER NEWS _____	0898 12 11 95
ENGLAND CLUBCALL _____	0898 12 11 96
SUPERCALL SPORT INDEX _____	0898 12 11 10

Calls are charged at 38p/min peak, 25p/min off peak inc. VAT Ⓟ



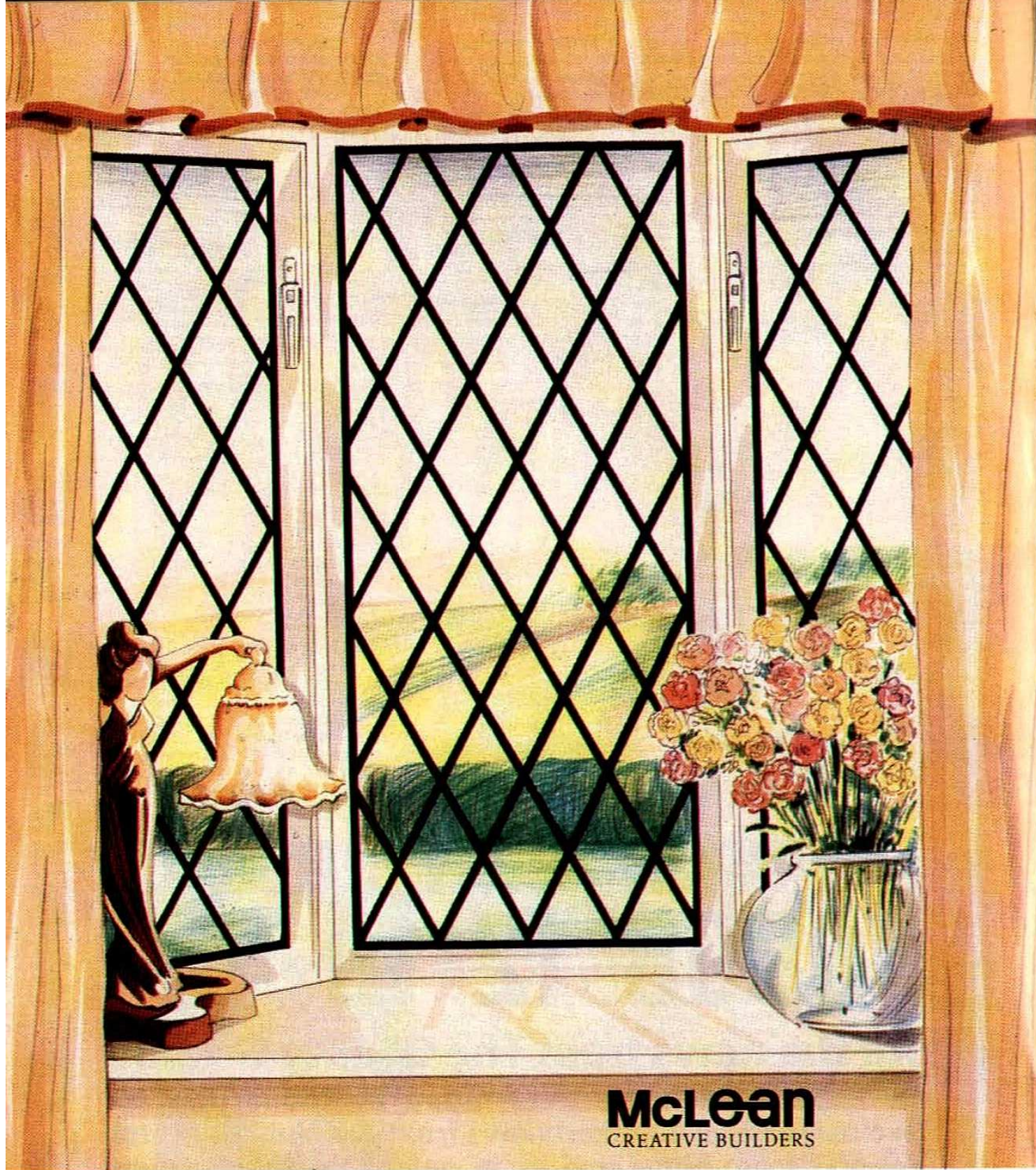

McLean
CREATIVE BUILDERS

**Admit it, you're beginning
to feel at home already.**

1. Your 1-2-3 forecast for the Second Division (not including Swindon Town).

1. Leeds United
2. Sheffield United
3. Oldham Athletic

2. The team you expect to make the most improvement.

Leicester City.

3. A tip for promotion from Division Three

Bristol City.

4. Select a team from players that you have played with at Club level.

1. Fraser Digby
2. David Kerslake
3. Paul Bodin
4. Alan McLoughlin
5. Colin Calderwood
6. Jon Gittens
7. Tommy Jones

8. Duncan Shearer
9. Steve White
10. Ross Maclaren
11. Steve Foley

5. The best player you have seen in your position.

Pele

(Mark Hughes in England at the present time).

6. Details of your first match, at any level, for your first professional Club.

Team and Opponents:

Swindon Town v
Wolverhampton Wanderers

Date of Match:

3 September 1989

Venue:

County Ground

Position played:

Centre Forward

Number of goals scored:

None

Final result:

3-1 to Swindon

7. Your favourite holiday spots at home and abroad.

Manchester.

Anywhere.

8. Your favourite sports commentators.

Harry Carpenter.

9. Your favourite publication for sport.

Match or Shoot.

Nicky Summerbee

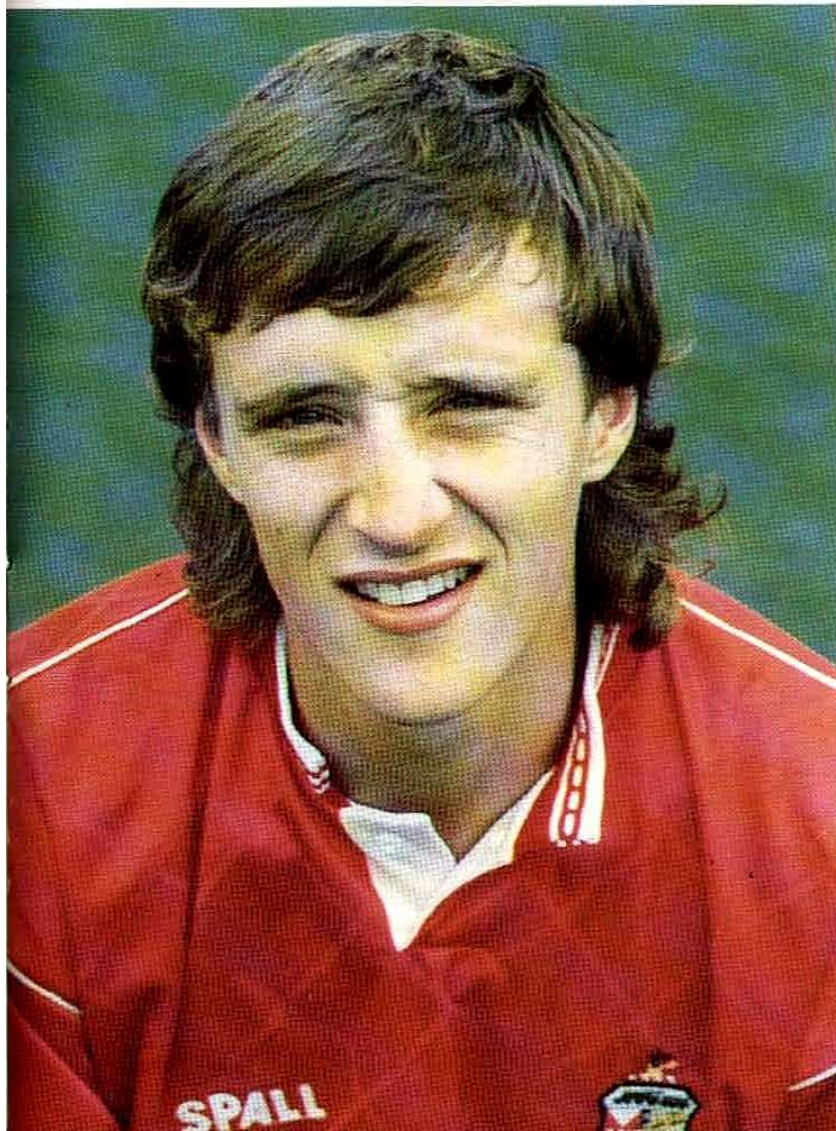

10. The best & worst dressers among your team mates.

Best – Alan McLoughlin

Worst – Steve White.

11. The best ground you have played on and the one you would most like to appear on.

Highbury

Old Trafford

12. Your worst moment on the football field.

None in particular.

13. What are your favourite TV shows.

Coronation Street

Brookside

Any sport programmes.

PERSONAL OPINION





● Ross Maclaren scoring Swindon's second goal against West Ham United.

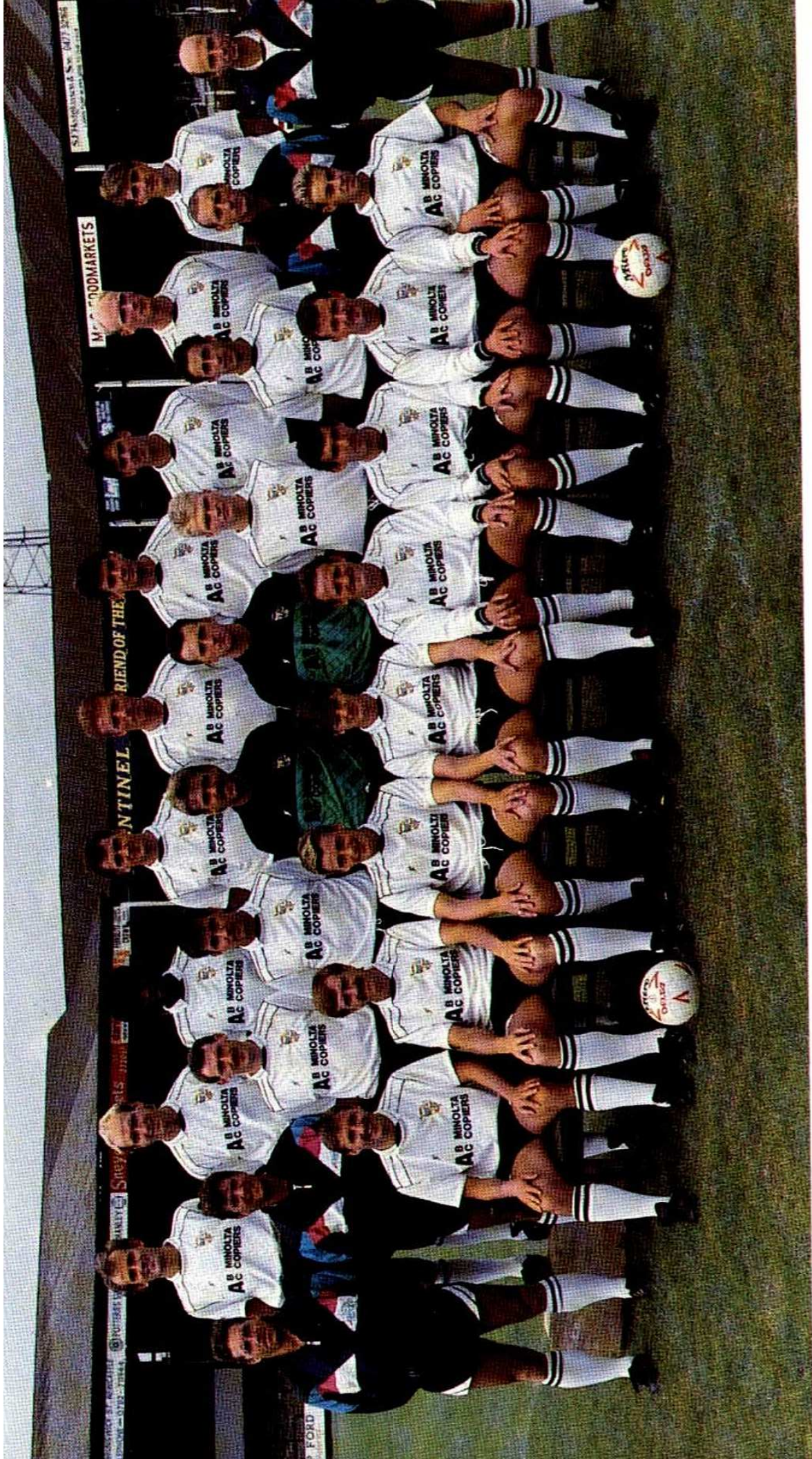

PORT VALE FOOTBALL CLUB 1989-1990

Back Row (left to right): Simon Mills, Ron Futchler, Robby Earle, Paul Millar, Ron Jepson, Gary West, Kevin Finney, Neil Aspin, Dean Glover.

Middle Row (left to right): Mike Pejic (Coach), Martin Copeland (Physio), Nicky Cross, Alan Webb, Mark Grew, Trevor Wood, Matt Booth, Darren Hughes, Steve Hunt (Youth Coach), John Rudge (Manager).

Front Row (left to right): David Riley, Ian Miller, Andy Porter, Ray Walker (Captain), Gary Ford, John Jeffers, Paul Atkinson, Glen Shepherd.

Form guide

PORT VALE FORM GUIDE 1989/90 (LAST 10 GAMES)

Date	Opponents	Home	Away	Goalscorers	Att.
Jan 1	Ipswich Town	W5-0		Beckford, Earle, Cross, Miller	8,617
7	Derby County	FAC	D1-1	Beckford	17,478
10	Derby County	FAC	W3-2	Own goal, Walker, Cross	21,389
13	West Bromwich Albion		W3-2	Cross, Beckford, Porter	13,575
20	Brighton & Hove Albion	W2-1		Cross	8,666
27	Aston Villa	FAC	L0-6		36,532
Feb 3	Stoke City		D0-0		22,075
10	Watford		W1-0	Earle	7,063
17	Blackburn Rovers		L0-1		9,240
24	Plymouth Argyle		W3-0	Hughes, Beckford, Mills	7,254

SUMMARY OF GOALSCORERS

Cross 13, Beckford 12, Earle 9, Fletcher 3 (to Burnley), Glover 3, Jeffers 2, Walker 2, Parkin 2 (1 for Swindon Town), Miller 2, Porter 1, Hughes 1, Mills 1, Own goals 3.

AGGREGATE home gates (including Cup):	163,091
Home League gates:	141,132
Away gates (including Cup):	255,425
Away League gates:	175,247
AVERAGE Home gates (including Cup):	9,098
Home League gates:	8,820
Away gates (including Cup):	12,163
Away League gates:	11,749

Welcome to

PORT VALE

JOHN RUDGE (Manager). Originally joined the Club as Coach in February 1980 and took over the Managers role in December 1983. Took the Club to promotion from Division Four in 1986 and into Division Two via the play-offs in 1989. As a player he appeared for Huddersfield, Carlisle, Bristol Rovers, Torquay and Bournemouth.

MARK GREW (Goalkeeper). Born Bilston. Joined Vale on free transfer from Ipswich Town in June 1986 and, despite missing virtually the whole of his first season through injury, has given excellent service ever since, topping 100 appearances. Began his career at West Bromwich Albion where he made an F.A. Cup semi-final appearance in 1982 and has also played for Leicester City, Notts County, Wigan, Oldham and Fulham, the last four on loan.

NEIL ASPIN (Defender). Born Gateshead. Close season capture from Leeds United for the sum of £200,000, equalling the Club record. Can play either at full-back or in the centre of the defence. Had completed over 250 senior appearances for the Yorkshiremen, his only previous Club, after making his debut in 1982 two months short of his 17th birthday.

TIM PARKIN (Defender). Born Penrith. Joined Vale last December from Swindon Town for a fee of £60,000. A formidable force in helping Swindon into last season's Division Two play-

offs. The previous year was voted Swindon Town's Player of the Year. Began as an apprentice at Blackburn Rovers, but has also seen service with Malmö and Bristol Rovers.

DEAN GLOVER (Defender). Born Birmingham. Became the Club's record signing for £200,000 from Middlesbrough in February 1988, beating the previous record five-fold. He sparked off a ten game unbeaten run upon his arrival and steadied the ship for the final run-in to promotion. Aston Villa was his first Club and he has been successful in the play-offs in each of the last two seasons.

DARREN HUGHES (Defender). Born Prescott. Speedy left-back who won an F.A. Youth Cup winners medal with his first Club, Everton, in 1984 before moving to Shrewsbury. A further move to Brighton followed and it was from there that he joined the Vale for £10,000 in September 1987 after a spell on loan. Has been a regular choice ever since and scored his first Vale goal against Brighton on the day of his permanent transfer.

RAY WALKER (Midfield). Born North Shields. Classy midfielder who cost £12,000 from Aston Villa in July 1986 after an earlier loan spell at Vale Park during the 1984/86 season. Chosen in the F.A. Cup Third Division team for the past two seasons. Is also the Club Captain.

ANDY PORTER (Midfield). Born Holmes Chapel. Turned professional in July 1987 after two years on the Y.T.S. scheme and began to hold down a regular place towards the end of last season.

ROBBIE EARLE (Midfield). Born Newcastle-under-Lyme. The Club's longest serving player, having made his debut in 1982 as a 17 year old. An enthusiastic midfielder player who was the country's leading goalscorer in that position last season with 19 goals including the one that clinched promotion in the play-offs against Bristol Rovers. Has now made over 250 senior appearances in a variety of roles including centre-forward and full-back.

SIMON MILLS (Defender/Midfield). Born Sheffield. Former England Youth International who began his career at Sheffield Wednesday, then moved to York where he topped 120 appearances. Joined Vale for £35,000 in December 1987 originally as a midfielder player and scored 5 goals in 19 appearances that season. Last season he spent the majority of the time at right-back.

GARY FORD (Midfield). Born York. Made over 400 appearances for York City before joining Leicester City from where he moved to Vale Park for £40,000 in December 1987.

IAN MILLER (Midfield). Born Perth. Experienced winger with over 500 senior appearances behind him. Signed on a free transfer during the last close season from Blackburn Rovers where he had spent 8 seasons, winning a Full Members Cup medal in 1987. Began his career with Bury and has also played for Nottingham Forest, Doncaster Rovers and, of course, Swindon Town.

KEVIN FINNEY (Midfield). Born Newcastle-under-Lyme. Highly rated youngster who turned professional in July 1987, making his League debut soon afterwards. Normally occupies a central midfield role but broke into the first team toward the end of last season as an emergency striker.

JOHN JEFFERS (Midfield). Born Liverpool. Had a loan spell at the Vale midway during last season and then made the move permanent from Liverpool for £30,000 just before the transfer deadline. A tricky left winger on his day. He joined the Vale for first team football and played his part during last season's triumph in the play-offs.

DAVID RILEY (Forward). Born Nottingham. Began his career at Nottingham Forest and, after loan spells at both Darlington and Peterborough, joined the Vale for £20,000 in October 1987. Finished that season as joint leading goalscorer with 10 goals, but played the majority of the season on the left.

DARREN BECKFORD (Forward). Born Manchester. Last season's leading goalscorer with 23 goals including three hat-tricks in only his second full season of regular League football. Joined Vale in July 1987 from Manchester City for £15,000 as a result of a Buy-A-Player fund after a spell on loan at the end of the previous season. Has also had a loan spell at Bury.

NICKY CROSS (Forward). Born Birmingham. Signed July 1989 from Leicester City for £125,000 for whom he scored ten goals last season. Began his career with West Bromwich Albion and then joined Walsall but has considerable Second Division experience.

PAUL MILLAR (Forward). Born Belfast. Won the Northern Ireland Young Player of the Year award in 1986 whilst with Glentoran, the same year that he scored a last minute winner in the Irish Cup Final. After playing in Europe he moved to Portadown and joined the Vale in December 1986 for £20,000. Injury restricted him to one reserve appearances last season.

TEAM NEWS



AKERS GARAGE LTD.

MAIN VAUXHALL/OPEL BEDFORD DEALERS

VAUXHALL - OPEL - BEDFORD - VAUXHALL - OPEL

VAUXHALL - OPEL - BEDFORD - VAUXHALL - OPEL

CAR/VAN SALES NEW & USED
Service Department M.O.T. Testing Station
BODY & PAINT REPAIR SHOP
Genuine Vauxhall /Opel /Bedford Spares
SELECTION QUALITY USED VEHICLES

AKERS

YOUR LOCAL VAUXHALL/OPEL/BEDFORD SPECIALIST

THE STREET, MOREDON, SWINDON SN2 3ES

Tel: (0793) 23457-8-9



SERVICE - PARTS - SALES - SERVICE - PARTS - SALES - SERVICE - PARTS - SALES - SERVICE

De Luxe Car Hire



- * OVER 100 CARS TO CHOOSE FROM INCL. AUTOMATICS.
- * SPORTS AND PRESTIGE CARS AVAILABLE.
- * NO MILEAGE CHARGE.
- * DELIVERY & COLLECTION SERVICE.
- * CHILD SEATS, ROOF RACKS & TOW BARS AVAILABLE.
- * OPEN 7 DAYS 9am - 6pm.

11 MARLBOROUGH ROAD

SWINDON 644996 (DAYTIME)

SWINDON 31205 (EVENINGS)



Last Saturday led to draws for the top three teams in the Second Division. Leaders Leeds United let a 2-0 home advantage slip against West Bromwich Albion in front of 30,000 fans. Chris Kamara opened the scoring with his first goal for the Yorkshire Club. Chapman added another for the Elland Road side, unbeaten on their own territory this season. Goodman and Bartlett struck for the visitors.

Deane salvaged a point for second-placed Sheffield United with an 87th minute equaliser.

Newcastle were on course for their first away League win since early December. They've only seven points from a possible 27 recently. The Blades, who are unbeaten in their last ten matches, went behind through a Morris own goal.

Swindon came back from Kenny Black's first minute goal for Portsmouth to pick up a point at Fratton Park. Their marksman was Alan McLoughlin, his sixteenth of the current campaign. Pompey are new managed by former Swindon Town skipper Frank Burrows.

Bottom-of-the-Table Stoke City lost 2-1 at Leicester after being in front at half-time, thanks to Biggins. Oldfield and Reid Responded for the Filbert Street faithful.

Oldham Athletic, the only ones in the country still involved in both the F.A. and Littlewoods Cups, left Ips-

wich still in search of their first win of the new decade, by beating them 4-1 at Boundary Park. Joe Royle's side is unbeaten for 34 fixtures on the plastic pitch. Marshall, in for injured top scorer Andy Ritchie, was on target twice in two minutes, Palmer was also on the scoresheet and Irwin for his first of the season. Wark got the con-

★ ★ ★ ★ ★ ★ ★ ★
 ★ **GWR FM** ★
 ★ **97.2 MHz** ★
 ★ ★ ★ ★ ★ ★ ★ ★

*Shaun
 Hodgetts*
 of GWR



solation goal for the Suffolk side.

Less than six thousand supporters saw Dumin score twice in Oxford's 3-1 home win against Middlesbrough. They had gone ahead through Simpson. Brennan was the away team marksman.

England Manager Bobby Robson watched Wolves' Steve Bull take his tally to twenty for the season against Watford at Molineux. He had another effort disallowed. Wilkinson netted the opener for the Hornets - Penrice hit the bar. Final score 1-1.

Plymouth Argyle are without a win in 12 matches after losing 3-0 away to Port Vale. Hughes, Beckford and Mills got the goals.

Sunderland had their first success in eleven outings, beating Brighton & Hove Albion 2-1 at Roker Park. Hauser scored them both while Hardyman had a penalty saved. Chivers struck late for the Seagulls in the 89th minute.

Paul Moulden scored the only goal of the game at Dean Court, his 13th of the season, as A.F.C. Bournemouth beat Bradford City.

The honours were even at the Oakwell Ground - Cooper and Jacobs scored for Barnsley and Hull City respectively.

Jimmy Quinn put West Ham United ahead at home to Blackburn Rovers, Sellars equalised against a London side led by Billy Bonds for the first time. It ended 1-1.

**G
 A
 M
 E
 S
 &
 G
 O
 A
 L
 S**

*in the
 Second
 Division*



MIKE KNIGHT TYRES

**SWINDONS No. 1 TYRE MAN
FOR THE BEST DEAL IN TOWN
PLEASE TRY MY TEAM FIRST**

MAIN DEALERS FOR DUNLOP, GOODYEAR,
PIRELLI, MICHELIN - PLUS COLWAY REMOULDS



BATTERY HOT LINE PLEASE RING TEL NO:

GEOFF PAGE SWIN 36023

Hundreds of 2 Year Guaranteed Batteries · Always in Stock · Ready to Fit All Cars

WESTCOTT PLACE

TEL: SWINDON 27380 TYRES

BATTERY HOT LINE: 36023

THIS DEPT TYRES & BATTERIES

TARMAC ACQUIRED
OUR ROYBOURNE DEPOT
FOR REDEVELOPMENT

SHRIVENHAM ROAD

TEL: SWINDON 20629 TYRES

TEL: SWINDON 52574 EXHAUSTS

THIS DEPOT TYRES, BATTERIES, EXHAUSTS

BAMPTONS



STRATTON ROAD,
SWINDON,
WILTSHIRE.

TEL: (0793) 35547/8/9

MOTOR VEHICLE ACCIDENT REPAIR SPECIALISTS

Approved by Major Insurance Companies



APPROVED
PORSCHE
BODY REPAIRER



JUNIOR ROBINS

BIRTHDAY CONGRATULATIONS

Gurminder Sahoto (Churchfields)	15
James Ody (Wootton Bassett)	14
Daniel Godwin (Nythe)	10

NEXT MEETING

on Monday at 5.30 p.m.
in the Alamo

PANINI QUIZ

Two Panini Football Yearbooks available for the first two all correct entries.

1. Which player has appeared for both today's teams this season?
2. Both today's Clubs have had full-backs who made over 700 League appearances for their only League Club. What are their names?
3. Port Vale are one of the few sides to reach an F.A. Cup Semi-Final while in Division 3. Name two of the others.

WELCOME

Today we welcome the Under 11 and Under 12 Youth Teams from Wells City F.C. who played two Junior Robins teams this morning before watching this afternoon's game. This is the third year that

Junior Robins have played the Wells teams, and this year's visit is taking place during Wells City's Centenary Year.

The Wells City Under 11 side have only started playing together this year, whilst the Under 12 side, after an indifferent start, are now having an excellent run, with four of their players in the League Select Side and also have several players at the local football excellence schemes.

The two teams are managed by Pay Bryne (likened to Gordon Banks in his playing days) and Dave House who have been actively involved with the Club for many years, either by playing or managing youth sides.

Face in the Crowd

Are you the face ringed in the photograph alongside? If you are, you've won two tickets for a S.T.F.C. home game this season. All you have to do is bring along your programme to Lisa, Joanne or Michelle at the Club reception office and claim your tickets. You can do this between 9.30 am and 5.00 pm Monday to Friday or between 9 am and 12 noon on Saturday first team home match days.



WARNING TV SURVEILLANCE

This ground is equipped with

CLOSED CIRCUIT TELEVISION

Installed with the help of a grant from the Football Trust. It is there to increase crowd safety and to help the police. Recording facilities enable film and photographs to be taken of disorder, which may subsequently be used in a court of law.

The Football Trust is funded entirely by the pools companies Littlewoods, Vernons and Zetters from their Spotting-the-Ball competition.

SPALL SPORTSWEAR LIMITED

Official Suppliers to Swindon Town F.C. and Many Other Leading League Clubs

DO CALL AND SEE DOUG WOODMAN AND VIEW THE LARGE RANGE OF FOOTBALL AND OTHER SPORTS GOODS AVAILABLE FROM THE OFFICIAL CLUB SHOP.
OPEN 9.00 to 12.00 2.00 to 5.00 DAILY

12-04-2012-25



Travel Club News

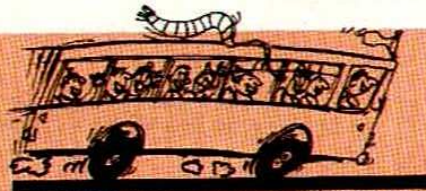

The new committee of S.T.F.C. Travel Club held their first meeting recently. The following Officers were appointed:

1. Mr. Mick Lewis - Chairman
2. Mrs. Janet Smith - Vice Chairman & Club Liaison Officer
3. Mr. Vincent Jupe - Treasurer
4. Mrs. Sheila Large & Mrs. Tracey Hartley - Joint Secretaries
5. Mr. Colin Aldridge - Lotteries etc.
6. Mr. Andrew Clinch - Steward

If you are not already a member, why not join and travel to away matches in comfort. The Travel Club runs coaches to all Swindon Town away matches. The official Travel Club also gets priority where away matches are all ticket. We

also intend to take coaches to some England matches at Wembley, our first trip being to England v Brazil on March 25th.

The Travel Club is open on Matchdays and on Tuesday, Wednesday and Thursday evenings from 7.30 - 10.00 p.m. Telephone bookings can also be made on these evenings.

So come and join us and support your team on the **Official Travel Club**.

Membership forms available at Travel Club Office. The future of the bookshop is under discussion with the Football Club. All programmes from away matches etc. will be available at Robins Corner Shop.

Looking forward to seeing you all
Janet Smith

We will be visiting **Plymouth Argyle** on **Saturday 10th March**. Your route will start via the **M4 west bound** then continuing along the **M5 south bound** until the end. From there proceed along the **A38 Plymouth by-pass** to **Tavistock Road A386**. Branch left to Plymouth **A386** then turn right then left into **Outland Road A3041** for **Home Park**.

MATCH DETAILS

Seats for the Town fans are available in the **Mayflower Stand** priced **£5.50 adults, £4.50 children and senior citizens**.

For those supporters wishing to **stand** the **Barn Park terrace** is available, ticket price is **£3.50, no concessions**. Entrance for the Town supporters will be via the **Barn Park turnstiles**, and **main entrance**.

Parking is available in the free car park adjoining the ground (2,000 spaces).

The nearest **railway station** is **Plymouth station**

with the CLUB

which is about 1 mile away. Telephone number **(0752) 21300**.

The nearest **police station** is **Devonport Station**, 1½ miles away.

Your matchday programme will cost **80p**.

More information concerning Plymouth Argyle can be

obtained by telephoning **(0752) 562561**.

PLYMOUTH ARGYLE HONOURS

Champions Division Three (South) 1929-30, 1951-52. Champions Division Three 1958-59.

PLAN OF HOME PARK

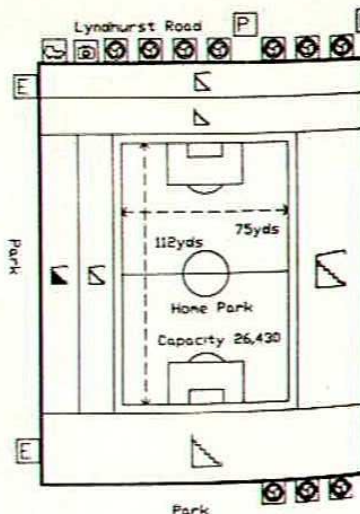

STREETS SURROUNDING HOME PARK

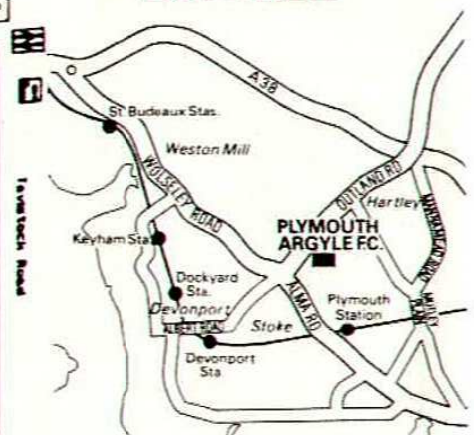

PENALTIES? YOU WON'T GET ANY AT BARCLAYS.

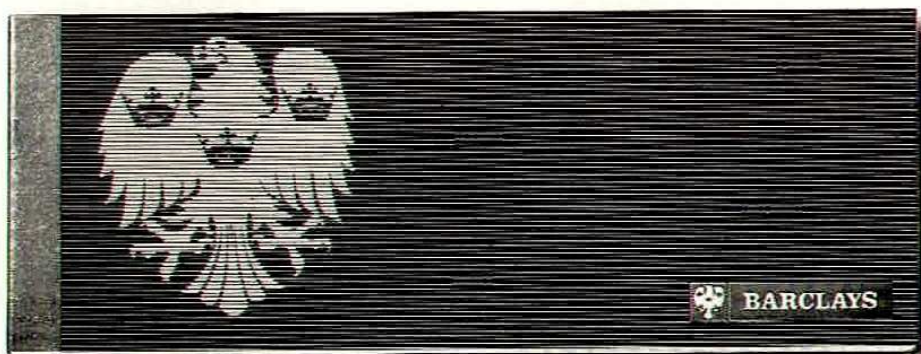

With The Barclays Bank Account you won't be charged for everyday transactions like cheques, credits and standing orders.

It has three options, two of which pay interest, and you can simply switch between them as your needs change.

Call into your local Barclays branch for further details. The Barclays Bank Account, in a league of its own.



THE BARCLAYS BANK ACCOUNT IS A CURRENT ACCOUNT FOR PERSONAL CUSTOMERS. AN OVERDRAFT FACILITY IS ONLY AVAILABLE ON APPLICATION. INTEREST RATES MAY VARY. WRITTEN DETAILS ARE AVAILABLE FROM BARCLAYS BANK PLC. PERSONAL SECTOR MARKETING, JUXON HOUSE, 94 ST. PAUL'S CHURCHYARD, LONDON EC4M 8EH. MEMBER OF IMRO.

**BARCLAYS LEAGUE
FIXTURES
DIVISION TWO
1989/90**



Sat Aug 19	Sunderland	0-2	10,199	Digby	Hockaday	King	McLoughlin	Parkin†	Calderwood	Galvin*	Shearer	White	Maclaren	Simpson	Ardiles*(7)	Cornwell†(5)
Sat Aug 26	Oldham Athletic	2-2	5,531	Digby	Barnard	King	McLoughlin	Parkin	Calderwood	Galvin*	Shearer*	White	Maclaren	Simpson	Ardiles*(9)	Cornwell†(8)
Sun Sept 3	Wolverhampton Wanderers	1-1	21,469	Digby	Barnard	King	McLoughlin	Gittens	Calderwood	Galvin*	Shearer†	White	Maclaren	Galvin*	Cornwell†(2)	Summerbee†(8)
Sat Sept 9	West Ham United	1-1	21,469	Digby	Barnard	King	McLoughlin	Calderwood	Gittens	Jones†	Close	White	Maclaren	Galvin*	Cornwell†(1)	Hunt
Sat Sept 12	Sheffield United	0-2	12,940	Digby	Barnard	King	McLoughlin	Calderwood	Gittens	Jones†	Close	White	Maclaren	Simpson†	Bodin*(7)	Hunt†(10)
Sat Sept 16	Barnsley	0-0	6,540	Digby	Barnard	King	McLoughlin	Calderwood	Gittens	Jones†	Shearer*	Bodin	Maclaren	Simpson†	Close*(8)	Galvin†(11)
Tue Sept 19	Shrewsbury (LC R1)	3-0	3,518	Digby	Hockaday	King	McLoughlin	Calderwood	Gittens	Jones†	Shearer	Bodin	Maclaren	Simpson*	Close	Galvin†(11)
Sat Sept 23	Leeds United	4-0	21,694	Digby	Hockaday	King	McLoughlin	Calderwood	Gittens	Jones†	Shearer†	Close	Maclaren	Simpson*	Bodin*(7)	Galvin†(8)
Tue Sept 26	Plymouth Argyle 7.45	0-0	6,862	Digby	Hockaday	King	McLoughlin	Calderwood	Gittens	Jones†	Shearer	Bodin	Maclaren	Simpson	McLoughlin†(4)	Close†(7)
Sat Sept 30	Bradford City	1-1	8,334	Digby	Hockaday	King	McLoughlin†	Calderwood	Gittens	Jones†	Shearer	Bodin	Maclaren	Galvin*	Simpson†(11)	White†(4)
Tue Oct 3	Shrewsbury (LC R1) 7.45	3-1	5,541	Digby	Hockaday	King*	McLoughlin	Calderwood	Gittens	Bodin†	Shearer*	White	Maclaren	Simpson*	Jones†(3)	Close
Sat Oct 7	Hull City	3-2	5,366	Digby	Hockaday	King*	McLoughlin	Calderwood	Parke*	Bodin	Shearer*	White	Maclaren	Simpson*	Close	Cornwell†(11)
Sat Oct 14	Ipswich Town	3-0	8,039	Digby	Hockaday	King	McLoughlin	Calderwood	Parke*	Bodin	Hunt†	White	Maclaren	Simpson*	Bodin*(7)	Galvin†(8)
Tue Oct 17	Oxford United 7.45	3-0	10,715	Digby	Hockaday	King	McLoughlin	Calderwood	Parke*	Bodin	Hunt	White	Maclaren	Simpson	Hunt†(7)	Jones†(2)
Sat Oct 21	Leicester City	1-2	9,547	Digby	Hockaday	King	McLoughlin	Calderwood	Gittens	Jones†	Shearer*	White	Maclaren	Simpson	Bodin†(3)	Hunt†(7)
Tue Oct 24	Bolton Wers (LC R3) 7.45	3-3	8,318	Digby	Hockaday†	King	McLoughlin	Calderwood	Gittens	Bodin*	Shearer*	White	Maclaren	Simpson	Hunt†(7)	Jones†(2)
Wed Nov 1	Brighton & Hove Albion	2-1	8,070	Digby	Hockaday	King*	McLoughlin	Calderwood	Gittens	Jones†	Shearer*	White	Maclaren	Simpson	Cornwell	Hunt†(9)
Sat Nov 4	Stoke City	6-0	7,825	Digby	Hockaday	Bodin	McLoughlin	Calderwood	Gittens	Jones	Shearer*	White†	Maclaren	Simpson	Cornwell†(2)	Hunt†(9)
Tue Nov 7	Bolton Wers (LC R3) 7.45	1-1	11,533	Digby	Hockaday†	Bodin	McLoughlin	Calderwood	Gittens	Jones	Shearer*	White	Maclaren	Simpson	Close	Galvin†(11)
Sat Nov 11	Middlesbrough	2-0	15,085	Digby	Hockaday	Bodin	McLoughlin	Calderwood	Gittens	Jones	Shearer	White*	Maclaren	Simpson	Close*(9)	Galvin†(4)
Tue Nov 14	Bolton Wers (LC R3) 7.45	1-1	14,129	Digby	Cornwell	Bodin	McLoughlin†	Calderwood	Gittens	Jones	Shearer*	White*	Maclaren	Simpson	Close†(2)	Foley†(2)
Sat Nov 18	Port Vale (F.A. Cup 1)	0-2	7,393	Digby	Cornwell†	Bodin	McLoughlin	Calderwood	Gittens	Jones	Shearer	White*	Maclaren	Simpson	Close†(2)	Foley†(2)
Tue Nov 21	Bolton Wers (LC R3) 7.45	2-1	11,238	Digby	Cornwell†	Bodin	McLoughlin	Calderwood	Gittens	Foley	Shearer*	White*	Maclaren	Simpson	Foley†(10)	Cornwell†(9)
Sun Nov 26	Portsmouth 3pm	2-2	10,438	Digby	Kerslake	Bodin	McLoughlin	Calderwood	Gittens	Jones	Shearer	White*	Maclaren	Simpson	Cornwell†(2)	Simpson†(9)
Wed Nov 29	Southampton (LC R4) 7.45	0-0	15,085	Digby	Kerslake*	Bodin	McLoughlin	Calderwood	Gittens	Jones	Shearer*	White†	Maclaren	Simpson	Cornwell†(1)	Cornwell†(9)
Sat Dec 2	Sunderland	2-3	7,326	Digby	Kerslake	Bodin	McLoughlin	Calderwood	Gittens	Jones	Shearer	White*	Maclaren	Foley†	Cornwell†(1)	Cornwell†(9)
Tue Dec 5	A.F.C. Bournemouth	0-2	10,282	Digby	Kerslake*	Bodin	McLoughlin	Calderwood	Gittens	Jones	Shearer	White*	Maclaren	Foley†	Cornwell†(1)	Cornwell†(9)
Sun Dec 10	Sheffield Utd (FA C 2) 3pm	2-1	3,223	Digby	Kerslake	Bodin	McLoughlin	Calderwood	Gittens	Jones	Shearer	White*	Maclaren	Foley†	Cornwell†(1)	Cornwell†(9)
Wed Dec 13	Millwall (ZDSC) 7.45	2-1	9,884	Digby	Kerslake	Bodin	McLoughlin	Calderwood	Gittens	Jones	Shearer	White*	Maclaren	Foley†	Cornwell†(1)	Cornwell†(9)
Sun Dec 17	West Bromwich Albion	4-3	8,426	Digby	Kerslake	Bodin	McLoughlin	Calderwood	Gittens	Jones	Shearer*	White*	Maclaren	Foley†	Cornwell†(1)	Cornwell†(9)
Sun Dec 17	West Bromwich Albion	2-1	9,884	Digby	Kerslake	Bodin	McLoughlin	Calderwood	Gittens	Jones	Shearer*	White*	Maclaren	Foley†	Cornwell†(1)	Cornwell†(9)
Sun Dec 17	West Bromwich Albion	2-1	9,884	Digby	Kerslake	Bodin	McLoughlin	Calderwood	Gittens	Jones	Shearer*	White*	Maclaren	Foley†	Cornwell†(1)	Cornwell†(9)
Tue Dec 20	Blackburn Rovers 3pm	1-1	11,857	Digby	Kerslake	Bodin	McLoughlin	Calderwood	Gittens	Jones	Shearer	White	Maclaren	Foley†	Cornwell†(1)	Cornwell†(9)
Sat Dec 30	Newcastle United	2-0	13,708	Digby	Kerslake	Bodin	McLoughlin	Calderwood	Gittens	Jones*	Shearer	White	Maclaren	Foley†	Cornwell†(1)	Cornwell†(9)
Mon Jan 2	Watford	1-2	17,488	Digby	Kerslake	Bodin	McLoughlin	Calderwood	Gittens	Jones*	Shearer	White	Maclaren	Foley†	Cornwell†(1)	Cornwell†(9)
Sat Jan 6	Bristol City (F.A. Cup 3)	3-2	7,742	Digby	Kerslake	Bodin	McLoughlin	Calderwood	Gittens	Jones†	Shearer	White*	Maclaren	Foley	Cornwell†(7)	Hockaday†(7)
Sat Jan 13	Oldham Athletic	1-2	19,014	Digby	Kerslake	Bodin	McLoughlin	Calderwood	Gittens	Jones†	Shearer	White*	Maclaren	Foley	Cornwell†(7)	Hockaday†(7)
Tue Jan 16	Southampton (LC R4 Replay)	2-4	19,014	Digby	Kerslake	Bodin	McLoughlin	Calderwood	Gittens	Jones†	Shearer	White*	Maclaren	Foley†	Cornwell†(7)	Hockaday†(7)
Sat Jan 20	Wolverhampton Wanderers	1-2	17,210	Digby	Kerslake	Bodin	McLoughlin	Calderwood	Gittens	Jones†	Shearer	White*	Maclaren	Foley†	Cornwell†(7)	Hockaday†(7)
Wed Jan 24	Norwich City (ZDSC 7.45)	4-1	5,314	Digby	Kerslake	Bodin	McLoughlin	Calderwood	Gittens	Jones	Shearer	White*	Maclaren	Foley†	Cornwell†(7)	Hockaday†(7)
Sun Feb 4	Leeds United	3-2	16,209	Digby	Kerslake	Bodin	McLoughlin	Calderwood	Gittens	Jones	Shearer	White*	Maclaren	Foley†	Cornwell†(7)	Hockaday†(7)
Sat Feb 10	Barnsley	1-0	7,179	Digby	Kerslake	Bodin	McLoughlin	Calderwood	Gittens	Jones*	Shearer	White†	Maclaren	Foley	Cornwell†(9)	Hockaday
Tue Feb 13	Crystal Palace (ZDSC)	0-1	6,024	Digby	Kerslake	Bodin	McLoughlin	Calderwood	Gittens	Jones	Shearer	White*	Maclaren	Foley	Cornwell†(9)	Hockaday
Sun Feb 18	West Ham Utd	2-2	16,105	Digby	Kerslake	Bodin	McLoughlin	Calderwood	Gittens	Jones	Shearer	White*	Maclaren	Foley	Cornwell†(9)	Hockaday
Sat Feb 24	Portsmouth	1-1	10,300	Digby	Kerslake	Bodin	McLoughlin	Calderwood	Gittens	Jones	Shearer	White*	Maclaren	Foley	Cornwell†(9)	Hockaday

Key: ● Goalscorer * and † Player substituted and () number of player substituted Home matches in bold type

**NEXT MATCH AT THE COUNTY GROUND
TUESDAY 6th MARCH 1990
SWINDON TOWN v BRADFORD CITY
BARCLAYS LEAGUE DIVISION TWO**

SECOND DIVISION LEAGUE TABLE

	P	W	D	L	F	A	W	D	L	F	A	Pts
Leeds United	31	12	4	0	33	12	6	8	5	23	24	40
Sheffield United	31	8	5	2	26	17	6	6	2	19	14	56
Swindon Town	31	8	4	3	35	20	6	5	5	21	23	51
Oldham Athletic	30	10	6	0	32	16	3	5	6	14	19	50
Sunderland	31	8	6	2	29	19	4	6	5	20	26	48
Blackburn Rovers	31	5	7	3	30	24	6	7	3	24	21	47
Wolverhampton Wanderers	31	8	4	4	26	16	4	6	5	21	23	46
Newcastle United	29	8	3	2	28	21	3	8	5	22	18	44
Port Vale	31	8	7	1	26	12	3	4	8	17	23	44
Oxford United	30	7	5	4	27	19	5	2	7	16	21	43
Ipswich Town	29	7	4	1	25	14	4	3	8	17	30	42
A.F.C. Bournemouth	31	7	5	4	21	19	4	3	8	21	29	41
Leicester City	30	8	4	4	28	17	2	6	6	16	21	40
West Ham United	30	7	2	5	24	17	2	7	7	13	21	40
Watford	31	3	8	5	23	25	5	4	6	16	21	36
Portsmouth	31	4	5	6	28	27	4	6	6	21	24	35
West Bromwich Albion	30	7	3	4	22	16	2	4	10	15	29	34
Middlesbrough	30	6	3	5	15	13	3	2	11	21	32	32
Brighton & Hove Albion	29	5	3	4	20	16	3	2	10	18	29	31
Plymouth Argyle	31	6	3	4	18	13	0	7	9	14	31	30
Hull City	30	2	5	7	13	22	4	8	4	23	33	31
Bradford City	31	6	3	4	16	19	3	8	14	33	30	30
Barnsley	30	3	4	6	16	19	3	8	14	33	30	30
Stoke City	31	4	5	5	18	19	1	5	10	8	30	26

**The
TRANSPLANT
GOALSCORING LEAGUE 1990**
Up to and including 2.3.90

Duncan Shearer	19
Steve White	18
Alan McLoughlin	16

Match Sponsor: Roy Allen Supplies Swindon
Match Ball Sponsor: South Marston Country Club

Match Sponsor	Team	Matchball Sponsor
Wheeleys Ltd, Swindon	Sunderland	Mr. Mortimore, Tooting
McLean Homes South West Ltd.	Wolverhampton Wanderers	Windmill Hill Garage, Swindon
Mr. C. Puffett, Multi Agg Quarries Ltd	Barnsley	Mr. D. Marchant
Blunsdon House Hotel	Plymouth Argyle	Blunsdon House Hotel
Allied Dunbar Ltd		
Swindon Color Gas Centre	Shrewsbury Town	Central South Television
The Plumb Center, Swindon	Ipswich Town	Baker Bros. Builders, Lambourn
Oxford and Swindon Co-Op. Society	Oxford United	ROVER GROUP
Walker Jackson & Co. Ltd. Main Dealers for Ford Cars & Iveco Ford Trucks	Bolton Wanderers	Cable Town F.C.
Mr. C. A. Sharples Esq.	A.F.C. Bournemouth	Mr. Raynor, Uni Mill Engineering
Arkells Brewery	Stoke City	Wilson Tool International Ltd
Sir Seton Wills and Friends	Bolton Wanderers	Data Call Systems Ltd. of Bristol
Skurrays, Drove Road, Swindon	Portsmouth	Mr Piper and Friends, Swiss Chalet
Heywood Insurance Brokers, Melksham	Southampton	Cliff Jones, Wessex Aluminium
Crosby Doors	Millwall	A.E. Smith & Son, Funeral Directors, Queens Drive, Swindon
Brunel Scaffolding, James Watt Close, Hawksworth Ind. Est., Swindon	Millwall	Data Call Systems Limited, 78/86 Pennywell Road, Bristol BS5 0TR
ROVER GROUP	Blackburn Rovers	Mr. Tremlin, Coped Hall Service Station
Swindon Garage Doors	Newcastle United	Hayman and Partners, Swindon
McLean Homes South West Limited	Oldham Athletic	Jenco Industries Ltd
	Norwich City	South Marston Country Club
Action Plant Limited	Leeds United	Cliff Jones, Wessex Conservatories
Transplant Ltd.	West Ham United	Our Friends from the Disabled Enc.
Roy Allen Supplies, Swindon	Port Vale	South Marston Country Club
The Holiday Inn, Swindon	Bradford City	The Holiday Inn, Swindon
Burmah Petroleum Fuels Ltd.	Hull City	Flow Forms (Wiltshire) Ltd
F. Green and Sons, Lambourn	Leicester City	The Pete Allen Traditional Jazz Band
Metalite Engineering Ltd, Swindon	Brighton & Hove Albion	Kesocasion M/F Kissograms 870806
Clarion Shoji (UK) Ltd.	Watford	Hammond Construction, Highworth
M & S Group Wholesale News and Books	West Bromwich Albion	ROVER GROUP
Texaco Ltd, Swindon	Middlesbrough	Emery McLaven Ott

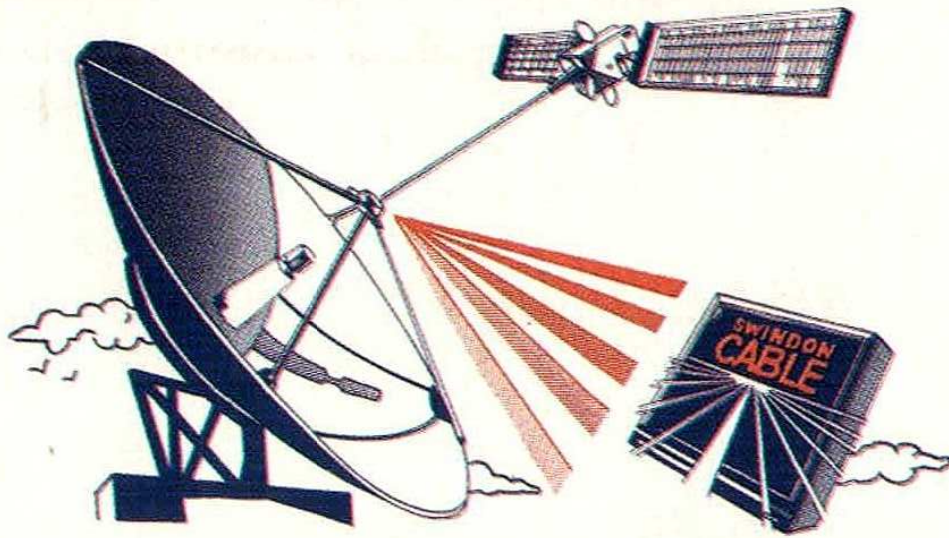

International coverage of all the major sporting favourites including; Athletics, Golf, Rugby, Wrestling, Gymnastics, Skating, Motor Racing and of course Football, together with live action from the new and exciting world of Speed Sailing, Windsurfing, Baseball, Body Building and Yachting.

plus a great deal more from

Swindon Cable – Your Local Cable & Satellite Television Company
Telephone: 0800 717121

THE FAMILY GAME

More and more clubs are providing modern facilities to enable families to watch and enjoy our national game in safety and comfort.

Family stands and enclosures are a common feature of League grounds and form part of a major programme to improve football stadia throughout the United Kingdom. This season will see

further projects including new and better toilet facilities, especially for female fans, the provision of seating in existing covered areas and improved accommodation for supporters with disabilities.

The Football Grounds Improvement Trust is responsible for all these measures. Each year it receives half of the £9.5 million donated by Littlewoods, Vernons and Zettors from their Spotting-the-Ball competition and spends it on schemes to improve standards at League grounds in Britain.



WALKER JACKSON

**Motoring...
we're on the
ball!**

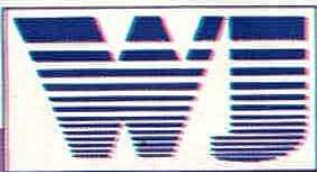

We're with you all the way!

Car Sales
Fleming Way
Roundabout
Tel: Swindon 20002

Car Service & Parts
Marlborough Road
Tel: Swindon 20002

Commercial Sales Service Parts
Coped Hall, Wootton Bassett
Tel: Swindon 853344



A Member of the Normand Group of Companies

TRANSPLANT CONSTRUCTION MACHINERY RENTAL



Reading Depot:
Transplant Limited,
Toutley Works, Toutley Road,
Wokingham, Berkshire RG11 5QN
Tel: Reading (0734) 786278
Fax: (0734) 792820

South Coast Depot:
Unit 10, Fort Fareham Ind. Est.,
Newgate Lane, Fareham,
Hampshire PO14 1AH
Tel: Fareham (0329) 822453
Fax: (0329) 822502



Bristol Depot:
Transplant Limited,
Emery Road, Brislington Trd. Est.,
Bristol BS4 5PF Tel: (0272) 779211
Fax: (0272) 711559

Swindon Depot:
Gipsy Lane,
Swindon
Tel: (0793) 542266
Fax: (0793) 731600

BULK EXCAVATIONS
Six and Eight Wheel
Hinos. Hire on Daywork
or Priced Basis.

**NEW
SOUTH COAST
DEPOT**

POWERED AERIAL ACCESS EQUIPMENT

These items may be hired from any of our depots, but for specialist advice contact our Manager

THE FORCE IN PLANT HIRE



Head Office and Accounts Telephone: Swindon (0793) 731741

GOALKEEPER

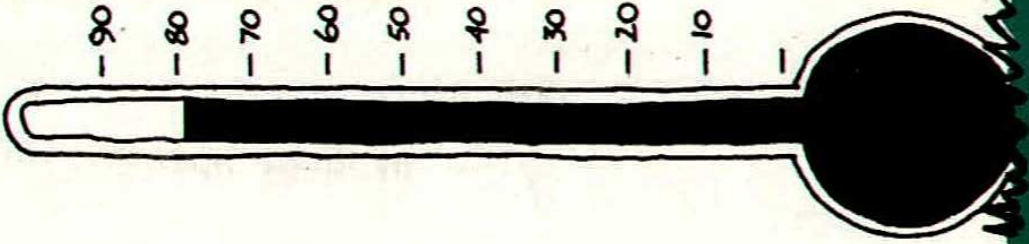
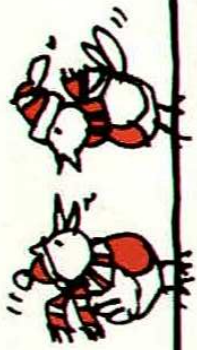

Clare Catering of Oxford	Metalite Engineering Swindon (0793) 692466	Blunsdon House Hotel Swindon 721701	Lovatt Heating Ltd. Cirencester (0285) 4698/60471	M and S Group Newspapers Swindon 39624	High Close Soft Fruit Hungerford (0488) 82973
Multi Agg Ltd. Shellingford Quarry 917 8949	Thamesdown Cleaning Swindon 527833	Brunel Scaffolding Swindon 31539	Regal Windows Swindon 618138	Starlight Private Hire Cars Swindon 694994	The Riverway Wire Co. Trowbridge (0225) 753655
Sun Ray Heating Swindon 695186	Swindon Color Gas Centre 613391	Roy Allen Supplies Swindon 644525	Sandra Coburn	Moore's Cars Faringdon (0367) 21487	Lee Smith Haulage Swindon 25789/31432
Rons Stores Swindon 23262	Keith Lodge Industrial Roofing Malmesbury (0666) 822496	Abbey Road Garage Cirencester (0285) 653560	Western Daily Press	Skurays Drive Road Swindon 20971	Haine and Smith Opticians Swindon 695452
	Stratton T.V. & HIFI Swindon 724335	Carling Black Label			

Swindon Town F.C. would like to thank the following sponsors who have sponsored the first team for every goal scored in competitive matches during season 1989/90

THE UNBEATABLE TEAM

DEACONS



PLUS

ROLEX

SALES
& SERVICE



DEACONS

(Established 1848)

11-13 WOOD STREET, SWINDON

Tel: 22072 and 27530

23 MARKET PLACE, TETBURY Tel: 52766



Hulford

Motors Ltd

SELF DRIVE HIRE SPECIALISTS
FOR OVER 30 YEARS

CAR &
VAN HIRE



SPECIAL LOW LONG WEEKEND RATES



SHRIVENHAM ROAD, SWINDON

534934 & 524839



SPECIALISTS IN
LTD.

*Process Pipework and Plant, Building Mechanical Services,
Industrial Fabrication, Sheet Metalwork, Combustion Services, Thermal Insulation,
Asbestos Removal, Engineering Merchants, Development Engineers*

THORNHILL, SOUTH MARSTON, SWINDON SN3 4TA.
TELEPHONE (0793) 825505 FACSIMILE (0793) 822642



CASTLE'S

Office and Bakery

4 and 5 MARKET STREET SWINDON

Telephone 522017

Specialists

Wedding Cakes, Birthday Cakes.

Try our Wholemeal Bread and

Wiltshire Lardies and

Delicious Dairy Cream Cakes

ELEGANT

Reproduction Furniture

Luxury . . .

you can afford



Qualities to suit all tastes . . .

Prices to suit all pockets . . .

Come and see for yourself at . . .

Howell's

Reproduction Furniture & French Polishing Specialists
52, DEVIZES ROAD, OLD TOWN



Swindon. Tel: 35658



'OVENDEN PAPERS' FOOTBALL COMBINATION LEAGUE TABLE
(up to and including Saturday 24th February 1990)

	P	W	D	L	F	A	Pts
Tottenham Hotspur	28	20	2	6	73	34	62
Millwall	31	18	8	5	49	27	62
Arsenal	26	17	4	5	60	41	55
Norwich City	27	16	4	7	54	28	52
Chelsea	25	14	5	6	55	32	47
Oxford United	28	12	6	10	51	41	42
Brighton & Hove Albion	27	11	5	11	40	46	38
Swindon Town	29	12	2	15	45	53	38
West Ham United	26	10	6	10	53	48	36
Ipswich Town	26	10	4	12	44	46	34
Luton Town	25	9	6	10	46	40	33
Portsmouth	24	6	11	7	24	34	29
Crystal Palace	23	7	6	10	33	31	27
Queens Park Rangers	24	8	3	13	40	58	27
Charlton Athletic	24	7	4	13	36	46	25
Watford	24	5	8	11	39	52	23
Reading	26	6	5	15	40	71	23
Southampton	26	3	8	15	24	45	17
Fulham	26	4	3	19	17	63	15

After three excellent victories we suffered a heavy defeat against near rivals Oxford.

It was a game in which we so often threatened to do well and create chances, yet rarely managed to do so. The flowing, controlled football of the previous weeks disappeared, leaving us with plenty of possession but no end product. Too many times we were forced to play backwards or to the side, consequently crossing and shooting opportunities were few and far between.

Oxford took the lead after eleven minutes when Beauchamp slid the ball in at the far post from a Heath cross. Then followed our best spell, Simpson, on his return from injury, twice forcing good saves from Oxford 'keeper Judge.

Andy Rowland's kit is sponsored by:
 Shirt: Mrs. C. Weavers, Haydon Wick
 Boots: R. K. Owen, Freisian Close
 Track Suit: Mrs. B. Hillier, Calne
 Training Kit: Roy Warren & Family, Lambourn
 Shorts/Socks: Chris Piper and Martin Bailey, Swiss Chalet, Gorse Hill

Then came a couple of lapses in concentration defensively, allowing substitute McDonnell to score twice,

Andy Rowland

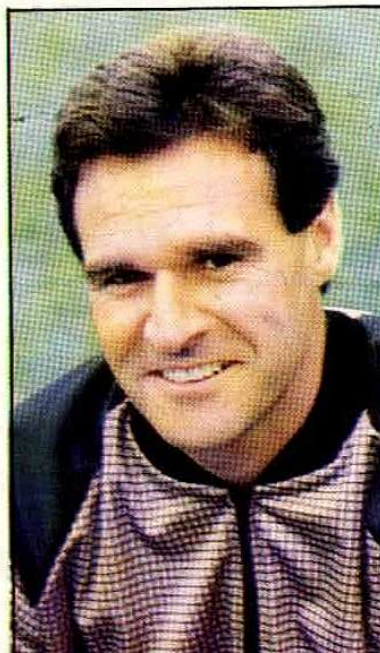

'OVENDEN PAPERS' FOOTBALL COMBINATION 1989/90

Date		Opponents	Result
1989			
Wed Aug 23		Portsmouth	2.00 H 2-0
Sat 26		Southampton	3.00 A 1-0
Tue 29		West Ham United	2.00 H 3-1
Sat Sep 2		Wimbledon	3.00 A 2-3
Tue 5		Oxford United	2.00 H 0-4
Wed 13		Fulham	2.00 H 5-0
Wed 20		Ipswich Town	3.00 A 0-3
Wed 27		Chelsea	2.00 A 0-6
Mon Oct 2		Millwall	2.00 H 3-1
Tue 10		Queens Park Rangers	2.00 H 1-2
Wed 18		Crystal Palace	2.00 A 1-2
Mon 23		Millwall	2.00 A 0-3
Tue 31		Luton Town	2.00 H 2-0
Tue Nov 7		Wimbledon	1.30 H 2-0
Tue 14		Queens Park Rangers	2.00 A 4-2
Thu 23		Arsenal	1.30 H 0-1
Tue 28		Charlton Athletic	2.00 A 1-2
Tue Dec 5		Brighton & Hove Albion	1.30 H 2-0
Sat 9		West Ham United	2.00 A 1-5
Tue 12		Portsmouth	7.00 A 0-0
Tue 19		Crystal Palace	1.30 H 2-3
1989			
Tue Jan 9		Watford	1.30 H 1-1
Tue 16		Reading	1.30 H 2-4
Wed 24		Brighton & Hove Albion	7.15 A 2-0
Sat 27		Watford	3.00 A 1-1
Tue 30		Chelsea	1.30 H -
Fri Feb 2		Norwich City	7.30 A 3-2
Tue 6		Tottenham Hotspur	1.30 H 1-0
Wed 14		Oxford United	7.30 A 3-0
Sat 17		Arsenal	3.00 A 3-2
Tue 20		Southampton	1.30 H 2-3
Wed 28		Fulham	2.00 A
Sat Mar 10		Luton Town	2.00 A
Tue 13		Ipswich Town	1.30 H
Tue 20		Charlton Athletic	1.30 H
Wed 28		Reading	2.00 A
Tue Apr 3		Norwich City	1.30 H
Tue 24		Tottenham Hotspur	2.00 A

the first when he stabbed home another Heath cross and the second when he chipped 'keeper Thompson from twenty yards. Although we raised our game in the second half we still failed to penetrate Oxford's defence, leaving us to ponder what might have been had we managed to get on the score sheet.

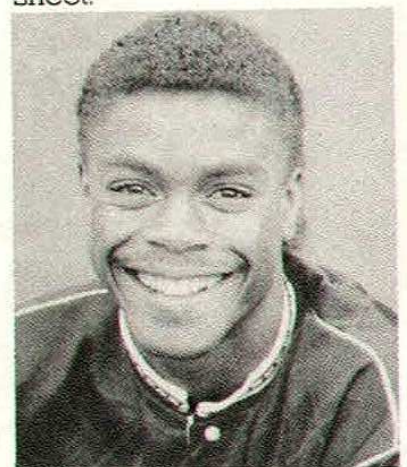

● **Fitzroy Simpson** - returned from injury.



**SOUTH EAST COUNTIES
v BRIGHTON & HOVE ALBION**
Saturday 17th February 1990
(away)

Result: Lost 4-0

Fielding a much-changed side due to Reserve Team calls, we gave a reasonable performance, giving us the chance to assess other players at his level. Always trying to play the right way and giving plenty of effort, the score did not reflect the balance of play. Two major factors brought about the defeat, mainly our inability to progress around or through the Brighton defence limiting us to very few openings due to lack of ideas in and around the penalty area. Basic defensive errors again proved costly at the other end.

As in previous games these basic mistakes are spoiling good performances when in possession and hitting players confidence. Could look to improve our ideas when in the attacking area.

Team: Lovegrove, Hall, Braidwood, Moyse, Churchward, Murray, Spalding, Howell, Spence, Goble, Phillips.

Substitutes: Buchanan (for Goble in 61 minute), **Thomson.**

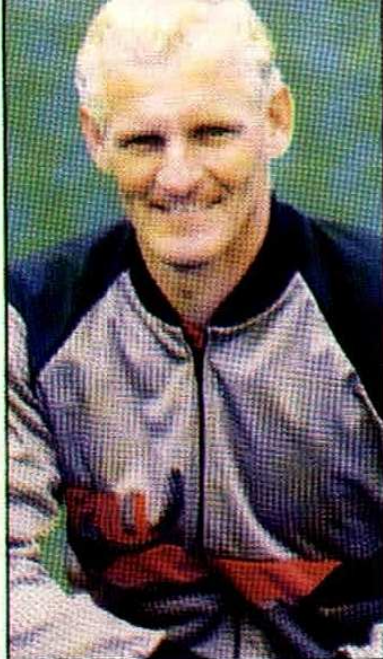

John Trollope

making them too late did not help to play good open football. Although having most of the game it took until the 38th minute to take the lead when Edwin Murray charged down a clearance for Robert Spence to score from the loose ball. The second half was better, playing some good football and Casey Goble put Spence away in the 62nd minute to score our, and his, second. The game was made safe when Goble intercepted a back-pass to score the third.

Once we got going we played some good football and, with a little more thought, could have played better, but a good improvement.

Team: Lovegrove, Hall, Braidwood, Phillips, Churchward, Thomson, Spalding, Howell, Goble, Murray, Spence.

Substitutes: Sharland (for Spalding in 67 minute), **Fishlock** (for Phillips in 61 minute).

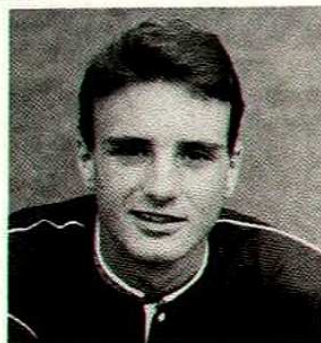

● **Robert Spence** - scored a double against Wokingham.

& YOUTH

**ALLIED COUNTIES
v WOKINGHAM**

Wednesday 21st February 1990
(away)

Result: Won 3-0

It took us a long time to get our game together, making the wrong decisions or

SOUTH EAST COUNTIES YOUTH TEAM SEASON 1989/90

Date 1989		Opponents	Result
Sat Aug 19	19	Reading	11 am H 1-1
Sat Aug 26	26	Oxford United	A 0-3
Sat Sep 2	2	Wimbledon	11 am H 0-3
Sat Sep 16	16	Tottenham Hotspur	11 am H 3-0
Sat Sep 23	23	Aldershot	A 3-2
Sat Sep 30	30	A.F.C. Bournemouth	A 3-1
Sat Oct 7	7	Luton Town	11 am H 1-2
Sat Oct 14	14	Colchester United	A 0-2
Sat Oct 21	21	Wimbledon	A 0-0
Sat Oct 28	28	Brighton & Hove Albion	11 am H 1-0
Sat Nov 4	4	Northampton Town	11 am H 2-3
Sat Nov 11	11	Southampton	11 am H 1-1
Sat Nov 18	18	Bristol City	A 2-1
Sat Nov 25	25	Crystal Palace	A 1-2
Sat Dec 2	2	Bristol Rovers	A 3-2
Sat Dec 9	9	Brentford	H 2-1
Sat Dec 16	16	Tottenham Hotspur	A 0-1
Sat Jan 6	6	Reading	A 0-2
Sat Jan 13	13	Oxford United	11 am H 0-5
Sat Jan 20	20	Wimbledon	A -
Sat Jan 27	27	Aldershot	11 am H 1-5
Sat Feb 3	3	Colchester United	12 noon H -
Sat Feb 10	10	A.F.C. Bournemouth	11 am H 1-3
Sat Feb 17	17	Brighton & Hove Albion	A 4-0
Sat Feb 24	24	Brentford	A 0-4
Sat Mar 3	3	Bristol City	11 am H
Sat Mar 17	17	Luton Town	A
Sat Mar 24	24	Southampton	A
Sat Mar 31	31	Crystal Palace	11 am H
Sat Apr 7	7	Northampton Town	A

SOUTH EAST COUNTIES LEAGUE CUP 1989/90

Date 1989		Opponents	Result
Sat Sep 9	9	Portsmouth	11 am H 2-3

MIDLAND YOUTH CUP 1989/90

Date 1989		Opponents	Result
Wed Aug 30	30	Peterborough United	A 3-0
Tues Jan 23	23	Nottingham Forest	

FA YOUTH CUP

Date 1989		Opponents	Result
Mon Oct 30	30	Portsmouth	7 pm H 2-3

SOUTH EAST COUNTIES LEAGUE

Division Two

	P	W	D	L	F	A	Pts
Crystal Palace	20	16	3	1	49	15	35
Oxford United	19	14	2	3	52	21	30
Colchester United	25	13	2	10	41	38	28
Southampton	22	10	6	6	32	27	26
Northampton Town	21	10	5	6	37	25	25
Brighton & Hove Albion	20	11	2	7	38	26	24
Wimbledon	22	9	5	8	44	23	23
Reading	22	10	3	9	34	25	23
A.F.C. Bournemouth	23	8	5	10	39	37	21
Luton Town	20	6	9	5	28	32	21
Brentford	22	7	5	10	37	39	19
Swindon Town	23	8	3	12	29	45	19
Bristol Rovers	22	8	2	12	37	48	18
Bristol City	22	7	3	12	27	33	17
Tottenham Hotspur	25	7	2	16	30	52	16
Aldershot	22	2	1	19	22	90	5

SOUTHERN JUNIOR FLOODLIT CUP

Date 1989		Opponents	Result
Mon Sep 11	11	West Bromwich Albion	A 0-2

**Nationwide Anglia Building Society
sponsor John Trollope's kit.**



SWINDON TOWN F.C. COMMUNITY

COMMERCIAL STAFF
 Commercial Secretary
 Robins Corner Manageress
Joyce Moore
 Lottery Organiser
Dave Hollister
 Superloot Organiser
Dennis Curtis
 Lottery Assistant
Des Lloyd

Welcome to the County Ground once again. Enjoy yourselves.

The
BIPLOB TANDOORI
Man of the Match
v West Ham United
 was
David Kerslake

David's prize was a Tandoori meal for two at either:
 The Biplob, High Street, Highworth.
 The Biplob, Wood Street, Swindon.
 The Biplob, Rodbourne Road, Swindon.

VIDEOS

Videos of all home matches can be obtained through the Commercial Department, Swindon Town F.C., County Ground, Swindon.
 V.H.S. Only.
 Full Colour.
 Cash/Cheque with order.
Collected £11.00. p/p £1.25 extra.
 EXCLUSIVE TO S.T.F.C.

SWINDON TOWN F.C.
Programme Collectors
Away Match Programme

Anyone who previously purchased Swindon Town F.C. away match programmes from the Travel Club Offices can, until further notice, purchase them from 'The Robins Corner' shop before and after all First XI matches.
 Programmes for our match with Barnsley on 10th February will be on sale on Sunday 18th February.

SPORTING DINNER
April 2nd 1990

at
South Marston Country Club
 Guest Speakers
 Ian Darke and Garry Richardson
 of BBC Radio Sport

A few tickets are still available at £16.00 from The Commercial Department, Swindon Town Football Club, County Ground, Swindon.
 Tel: (0793) 642994 ext. 30 or 31.



DOUG
Buswell



Name Richard Goodwin
 Age 10 years
 Address Burton-on-Trent
 Favourite Team Port Vale
 2nd Favourite Team Spurs
 Favourite Player Dean Glover
 2nd Favourite Player Nicky Cross

Today's Sponsor

ROY ALLEN SUPPLIES
21 WESTMEAD
WESTLEA
SWINDON

The Directors of Swindon Town Football Club would like to express their gratitude to

Roy Allen Supplies
 for their generosity in sponsoring today's match.

SWINDON TOWN
CLUB CALL
0898 12-16-40

★ ★ ★ ★ ★ ★ ★ ★ ★ ★
 ★ **New Consignment of** ★
 ★ **'OSSIE ARDILES'** ★
 ★ **Sweatshirts** ★
 ★ **arrived in** ★
 ★ **'The Robins Corner'** ★
 ★ **Souvenir Shop** ★
 ★ **Black/Red & Red/Black** ★
 ★ **Colour Combinations** ★
 ★ **Sizes: Medium & Large** ★
 ★ **Price £16.50** ★
 ★ **Also available from** ★
 ★ **The Commercial Department** ★
 ★ **& North Stand Kiosk** ★
 ★ ★ ★ ★ ★ ★ ★ ★ ★ ★

Today's Mascots



Name Jonathan Neve
 Age 10 years
 tomorrow
 Address Littleton Panel
 Nr. Devizes
 Plays for School Team
 Favourite Team Swindon Town
 Favourite Player Fraser Digby



FOR SPORT, NEWS, INFORMATION AND ENTERTAINMENT 24 HOURS A DAY, CALL THE GWR RADIO LINE ON 0898 333000
 Calls charged at 39p/min peak/25p/min all other times

THE WESSEX CONSERVATORY.



A GAMES ROOM FOR THE CHILDREN WITH TOUGHENED GLASS FOR SAFETY'S SAKE.



Yes, a Wessex Conservatory is a superb place for children to play.

Not just because it's light and airy but, with toughened glass, it's as safe as houses.

It also makes an extra living room for all the family.

A room that needs the minimum of maintenance because it never needs a lick of paint, just the occasional wipe.

And, because it has a unique glazing system, it controls ventilation and keeps the weather at bay.

Another unique feature, a glass treatment called "Clear-Shield," not only makes the glass easy to clean but also helps it stay clean.

What's more, they carry a ten year guarantee and they're also made to measure.

You see, we specialise in making individual conservatories and never toy around to convert standard models.

Most people can see through that little game.

So, for further details, contact Wessex Aluminium Limited, Hawksworth, Swindon SN2 1DZ. Telephone: (0793) 644633.

WESSEX
CONSERVATORIES
Tailor-made by the specialists

SWINDON TOWN

Manager: Ossie Ardiles



PORT VALE

Manager:
Colours:

John Rudge
White
with Black 'V' Neck

TEAM UPDATE

FRASER DIGBY. The highly-rated goalkeeper has not missed a game so far this season.



MARK GREW. Is currently in the best form of his career. Vale are his ninth Club!

DAVID KERSLAKE. Recently the subject of speculation concerning Glasgow Rangers and Real Madrid. Will shortly be moving into his new home in Swindon.



SIMON MILLS. Switched from midfield to full-back after the unfortunate Alan Webb sustained a broken leg in Vales' 2-2 draw at Newcastle.

PAUL BODIN. Won a Wales Under-21 International Cap in 1983 as a 19-year-old when with Cardiff City.



DARREN HUGHES. Scored his first goal of the season in last week's 3-0 win over Plymouth Argyle.

ALAN McLOUGHLIN. Took advantage of a defensive mistake to net the Town's equaliser at Portsmouth last week. 75th League appearance for Swindon today.



RAY WALKER. The stylish midfielder has been in brilliant form lately. Has been the subject of enquiries from several of the country's leading Clubs.

COLIN CALDERWOOD. The Stranreer-born defender jetted off to Spain with the rest of the 'Town' squad this week.



NEIL ASPIN. Has proved a big hit with Vale's fans since his summer move from Leeds United.

JON GITTENS. Saw his header cannon off the crossbar at Vale Park last November.



DEAN GLOVER. A former teammate of Ray Walker at Aston Villa. Signed from Middlesbrough during last season.

TOMMY JONES. Impressed Ron Atkinson during the recent live Sky TV coverage of our Zenith Cup match at Crystal Palace.



ANDY PORTER. The former YTS player scored his first goal of the season in Vales' recent 3-2 success at West Bromwich Albion.

DUNCAN SHEARER. Will be looking to get back to scoring form today to add to the 19 he has so far this season.



ROBBIE EARLE. Scored the goal which clinched promotion against Bristol Rovers in the play-offs last season.

STEVE WHITE. Substituted at Portsmouth after sustaining a rib injury. The Chipping Sodbury-born striker has 131 League goals in his career to date.



NICKY CROSS. The £125,000 signing from Leicester scored Vales' second in our 2-0 defeat at Vale Park.

ROSS MACLAREN. Another long-range strike in the 2-2 draw with West Ham United a fortnight ago, that being his fifth goal of the season.



DARREN BECKFORD. Has scored 12 goals so far to add to the 23 he got last term when he was the Clubs leading scorer.

STEVE FOLEY. Won a Central League Championship medal in the same Liverpool reserve team as Ian Rush.



JOHN JEFFERS. Scored his first-ever goal for the Club in the 2-1 defeat by Oxford United in November.

DAVE HOCKADAY. The Clubs' longest-serving player, he has been at Swindon since 1983. Recently returned after injury.



TIM PARKIN. The former 'Town' defender was a popular figure at the County Ground. Scored in his second appearance for Vale at Oldham on Boxing Day.

FITZROY SIMPSON. Returned after a long absence through injury to help the 'Town' to a share of the points at Fratton Park last week.



PAUL MILLAR. The Belfast-born striker has made 3 full and 11 substitute appearances this season. Scored in the 2-2 draw at Sunderland.

REFEREE

Mr. M. E. Pierce



LINESMAN YELLOW TRIM

Mr. T. A. Cobby

LINESMAN RED TRIM

Mr. A. G. Beale

RESERVE OFFICIAL

Mr. M. D. Jones

IMPORTANT SAFETY NOTICE

IMPORTANT SAFETY ANNOUNCEMENTS BY THE CLUB MANAGEMENT OVER THE PUBLIC ADDRESS SYSTEM WILL BE PRECEDED BY A LOUD SIGNAL TO CATCH THE ATTENTION OF SPECTATORS.

